

JETVAC INDUSTRIAL

Jetvac Industrial is a steam cleaner with stainless steel body and boiler, designed for industrial use and able to deliver dry saturated steam at 183°C temperature. Equipped with a wet&dry vacuum cleaner with an induction turbine.

A sturdy structure, a fully electric operation and the compact size allows any usage in any environment, both outdoors (watertight protection IPX5) and indoors (production lines).

All functions can be managed on the electronic control panel



Duplex

JETVAC INDUSTRIAL

Three-phase steam generator for usage in the industrial sector, with a stainless-steel body (watertight protection IPX5), **unlimited steam autonomy** thanks to the automatic refilling system with either an internal water tank (electromechanical water level control system inside the boiler – True Temp™) or directly with a water mains connection. **Possibility to inject detergent or hot water together with steam.** The steam generator's front panel is **equipped with an electric console with commands for a timer, a thermometer and a pressure gauge; the digital display will advise the user about the necessity to proceed with the boiler maintenance.** Combined with the three-phase vacuum unit Vac Industrial with a turbine engine of 3kW.

GENERATOR TECHNICAL DATA		
Boiler		Stainless steel AISI 304 with interchangeable heating element
Body		Stainless steel AISI 304 BA
Boiler volume	l	10,8 14,4: 11 - 21,6: 12,5 - 28,8 36: 14
Water tank	l	20
Detergent tank	l	20
Operating pressure	bar	10
Steam production	g/min.	291 - 388 - 582 - 776 - 970
Steam production	Kg/h	17,5 - 23 - 35 - 46,5 - 58
Steam T°	°C	183
Detergent T°	°C	90 - 160
Power supply	V-Hz	400 3~ - 50/60
Maximum output*	kW	11 - 17,8 - 22 - 32,2 - 39,4
Boiler output	kW	10,8 - 14,4 - 21,6 - 28,8 - 36
Power cord	m	8
VACUUM TECHNICAL DATA		
Vacuum output	kW	1
Vacuum drum capacity	l	7,5 14
Air flow	m3/h	200
Depression	mm	2200
Weight	Kg	113
Packaging	cm	150 x 55 x 80
Quantity unit/pallet	n°	1



GENERATOR PRICES	code
10,8 kW	5W05110
14,4 kW	5W04110
21,6 kW	5W03110
28,8 kW	5W02110
36 kW	5W01110

VACUUM CLEANER

TOOLS

GEYSER 1 10bar - STEAM Remember to apply the accessories on the nozzle and not directly on the lances to limit the pressure drop.



	code
5m	7105W12
8m	7108W12
10m	7110W12
15m	7115W12



	code
250 mm	7002512
350 mm	7003512
450 mm	7004512



	code
100mm	7100011
400mm	7100111
800mm	7100121
1200mm	7100131



	code
250 mm	7000252V1
350 mm	7000352V1
450 mm	7000452V1



	code
10,8kW: Ø 2,5 mm	UG71311
14,4: Ø 2,9 mm	UG71411
21,6kW: Ø 3,4 mm	UG71511
28,8kW: Ø 3,75 mm	UG71611
36kW: Ø 4 mm	UG71711



	code
1. Flat nozzle 1 cm	UG00052
2. Stainless steel brush T50	1207003
3. Stainless steel floor scrubber brush	1200002
4. Stainless steel flat nozzle w/scraper	7000012

RADAMES 10bar - STEAM/VACUUM



	code
4m	702140TW
8m	702180TW
12m	702112TW



	code
Kit	KRAT00
1. Extension tube (x2)	71030G4
2. Floor tool	71040G4V1
3. Insert squeegee/squeegee L.375	510410
4. Insert squeegee/brush L.375 (x2)	510420



	code
10,8kW: Ø 2,5 mm	71072G4
14,4kW: Ø 2,9 mm	71073G2
21,6kW: Ø 3,4 mm	71074G2
28,8kW: Ø 3,75 mm	71075G2
36kW: Ø 4 mm	71076G2
6. Brass brush Ø 28	120717
7. Stainless steel brush Ø 28	120709
8. Stainless steel brush Ø 60	120727
9. Steel wool pad	120712



	code
10. Steam/vac industrial brush L.530	7104005
11. Stainless steel upholstery tool	61002A2V1



DETERGENTS



	code
VapoFood 5L tank	LQ80065
VapoClean 5L tank	LQ80075

WATER TREATMENT SYSTEMS



	code
Water softener cartridge with resins for medium water consumption	FL00009
Water softener with automatic regeneration of resins through sodium chlorite for high water consumption	FL00008

GEYSER 1 10 BAR accessories

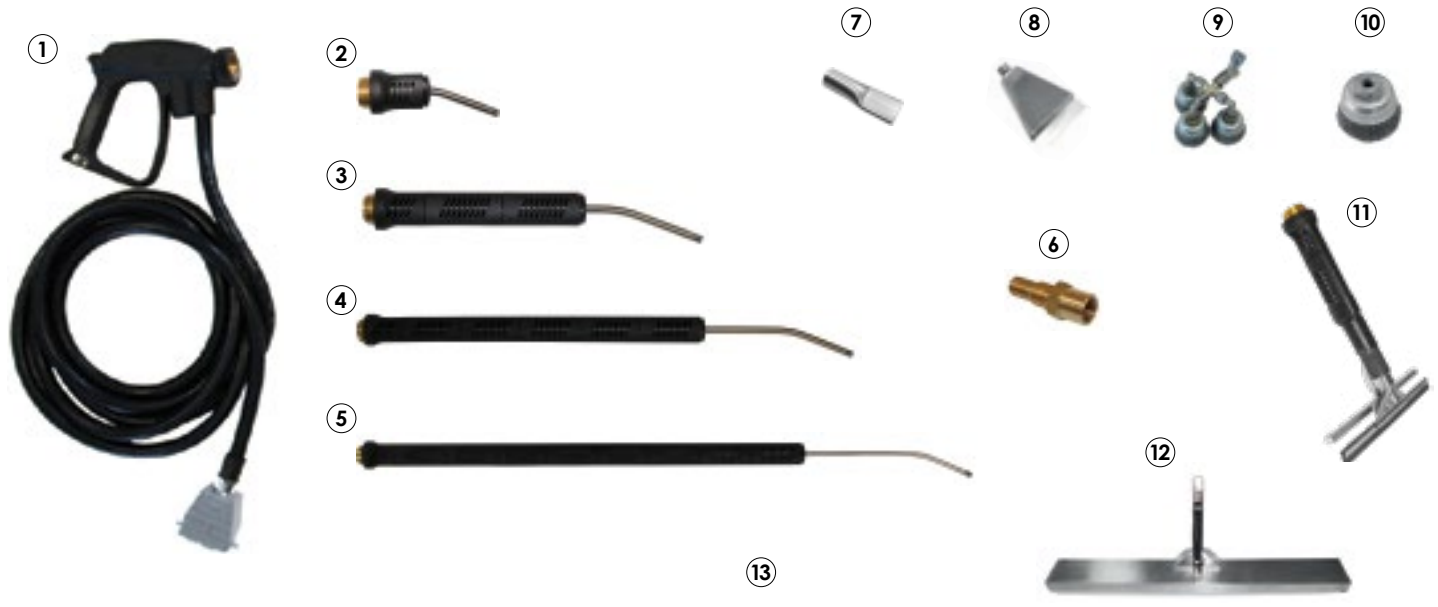

Hoses:

(for machines without overheated water injection)

	Code
5m 12P	7105012
8m 12P	7108012
10m 12P	7110012
15m 12 P	7115012

Hoses:

(for machines with overheated water injection)

	Code
5m 12P	7105W12
8m 12P	7108W12
10m 12P	7110W12
15m 12 P	7115W12

Lances:

		Code
2.	Lance 100 mm	7100011
3.	Lance 400 mm	7100111
4.	Lance 800 mm	7100121
5.	Lance 1200 mm	7100131

Nozzles:

		Code
6.	36 kW: Nozzle Ø 4,00 mm	UG71711
	28,8 kW: Nozzle Ø 3,75 mm	UG71611
	18-21,6 kW: Nozzle Ø 3,40 mm	UG71511
	14,4 kW Nozzle Ø 2,90 mm	UG71411
	10,8 kW: Nozzle Ø 2,50 mm	UG71311
	7,2 kW - 3,6 kW: Nozzle Ø 2 mm	UG71312

Remember to apply the accessories 7-10 & 12 on the nozzle n° 6 and not directly on the lances n° 2-5 to limit the pressure drop.

Accessories:

		Code
7.	Flat nozzle 1 cm	UG00052
8.	Stainless steel flat nozzle w/scraper	7000012
9.	Stainless steel floor scrubber brush	1200002
10.	Stainless steel brush T50 <i>(not compatible with old non-threaded nozzles/no mounting on the lance directly)</i>	1207003
	Window cleaner with diffuser:	
11.	250 mm	7002512
	350 mm	7003512
	450 mm	7004512
12.	Steam brush w/bristles:	
	250 mm	7000252V1
	350 mm	7000352V1
	450 mm	7000452V1
13.	*GEYSER/JULY 10bar ADAPTER <i>to be used with July 10bar accessories</i>	5107520

RADAMES 10 BAR accessories



Hoses:

for mod. Steam Box Pro, Steam Box Mini and Steam Tech without overheated water injection

	Code
4m 12P	702040T
8m 12P	702080T
10m 12P	702012T

Hoses:

for mod. Steam Box Pro, Steam Box Mini and Steam Tech with overheated water injection

	Code
4m 12P	702040TW
8m 12P	702080TW
10m 12P	702012TW

Hoses:

for mod. Steam Box Industrial with overheated water injection

	Code
4m 12P	702140TW
8m 12P	702180TW
10m 12P	702112TW

Accessories:

	KIT	Code
	KRAT00	
2.	Extension tube 10 bar	71030G4
3.	Floor tool 10 bar	71040G4V1
4.	Insert squeegee/squeegee L.375	510410
5.	Insert squeegee/brush L.375	510420

Optional:

		Code
	Steam/vac turbo lance 10 bar:	
6.	36 kW: Nozzle Ø 4,00 mm	71076G2
	28,8 kW: Nozzle Ø 3,75 mm	71075G2
	21,6 kW: Nozzle Ø 3,40 mm	71074G2
	14,4 kW: Nozzle Ø 2,90 mm	71073G2
	10,8 kW: Nozzle Ø 2,50 mm	71072G4
	7,2 kW - 3,6 kW: Nozzle Ø 2 mm	71071G2
7.	Brass brush Ø 28	120717
8.	Stainless steel brush Ø 28	120709
9.	Stainless steel brush Ø 60	120727
10.	Steel wool pad	120712
11.	Brass brush 8cm	1207822
12.	Stainless steel brush 8cm	1207812
13.	Steam/vac industrial brush L.530	7104005
14.	Insert stainless steel/stainless steel L.375	51043A
15.	Stainless steel upholstery tool	61002A2V1

JULY 10 BAR accessories for models from 7,2 to 14,4kW



Hoses:

	code	
1.	for mod. without overheated water injection	
	5m 12P	7052I3TV1
	8m 12P	7082I3TV1
	10m 12P	7102I3TV1
	15m 12P	7152I3TV1
	for mod. with overheated water injection	
	5m 12P	7052I3TWW1
	8m 12P	7082I3TWW1
10m 12P	7102I3TWW1	
15m 12P	7152I3TWW1	

Accessories:

	Code	
2.	Extension tube 10 bar	12030GRV1
3.	Rectangular brush 10 bar	12040GRV1
4.	Triangular brush 10 bar	12050GRV1
5.	45° curved bayonette lance 10 bar	
	14,4 kW: Nozzle Ø 2,90 mm	7207552
	10,8 kW: Nozzle Ø 2,50 mm	7207542
	7,2 kW - 3,6 kW: Nozzle Ø 2 mm	7207532
6.	Bayonette lance 10 bar	
	14,4 kW: Nozzle Ø 2,90 mm	7207522
	10,8 kW: Nozzle Ø 2,50 mm	7207512
	7,2 kW - 3,6 kW: Ø 2 mm	7207502
7.	Stainless steel threaded brush T50	1207003
8.	Brass threaded brush Ø 28	1207162
9.	Threaded stainless steel brush Ø 28	1207092

JULY 10 BAR accessories for models with 3,6 kW



Hoses:

		code
1.	for mod. without overheated water injection	
	5m 12P	705213TV1
	8m 12P	708213TV1
	10m 12P	710213TV1
	15m 12P	715213TV1
	for mod. with overheated water injection	
	5m 12P	705213TWW1
	8m 12P	708213TWW1
	10m 12P	710213TWW1
	15m 12P	715213TWW1

Accessories:

		Code
	KIT	KJAT00
2.	Extension tube 10 bar	12030GRV1
3.	Rectangular brush 10 bar	12040GRV1
4.	Triangular brush 10 bar	12050GRV1
5.	Steam lance 10 bar	12073GRV1
6.	Brass brush Ø 28	120717
7.	Stainless steel brush Ø 28	120709
8.	Stainless steel brush Ø 60	120727
9.	Steel wool pad	120712

Optional:

		Code
10.	Bayonette lance 10 bar	7207502
11.	45° curved bayonette lance 10 bar	7207532
12.	Brass brush 8cm	1207822
13.	Stainless steel brush 8cm	1207812
14.	Stainless steel threaded brush T50 <i>usable with the bayonette lance</i>	1207003
15.	Brass threaded brush Ø 28 <i>usable with the bayonette lance</i>	1207162
16.	Threaded stainless steel brush Ø 28 <i>usable with the bayonette lance</i>	1207092

WET/DRY INDUSTRIAL accessories



KIT: PG570I/ PG570IEX



OPTIONAL



		Code	Code
		NO ATEX	ATEX
1.	5m vacuum hose PVC Ø 50mm for each additional meter	7002076	7002076EX

Accessories:	NO ATEX	ATEX
	Code	Code

	KIT	PG570I	PG570IEX
2.	Double elbow tube	7002046	7002046
3.	Flat chromed steel nozzle Ø 50mm	7002056	7002056
4.	Floor tool for liquids	7002006	7002006
5.	Floor tool for dust	7002016	7002016
6.	Sucker nozzle Ø 50mm	7002026	7002026
7.	Flat nozzle Ø 50mm	7002066	7002066EX
8.	Round dust brush Ø 50mm	7002036	7002036EX
9.	90° curved conic lance	7003010	7003010
10.	Conic tool	7004010	7004010

SPECIAL PROFESSIONAL ACCESSORIES

Radames floor tool with 3 strips 10bar

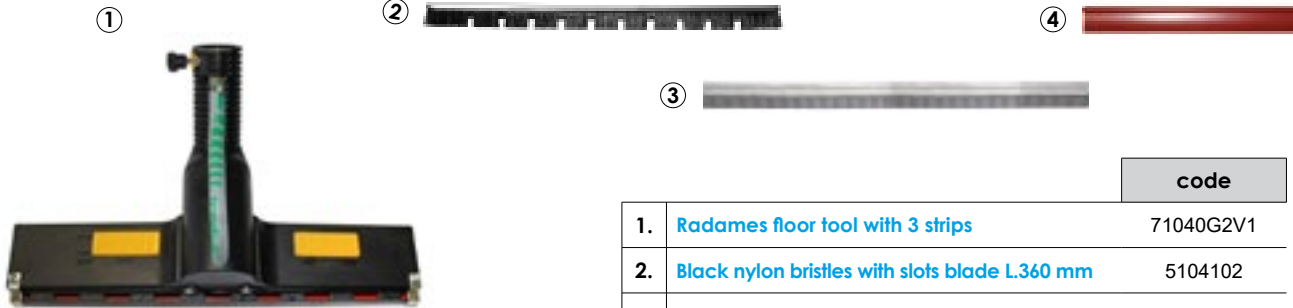

		code
1.	Radames floor tool with 3 strips	71040G2V1
2.	Black nylon bristles with slots blade L.360 mm	5104102
3.	Neoprene squeegee blade L.360 mm	510425
4.	Red squeegee blade L.360 mm	PG59510

Radames floor tool with 3 strips 10bar 2 squeegees & 1 white nylon bristles strip



code
7104015



		code
1.	Radames floor tool L.145 mm	7003002
2.	Neoprene squeegee blade L.145mm	5104253

Radames floor tool L.140mm w/nylon bristles RADAMES steam/vac turbo lance with suction nozzle

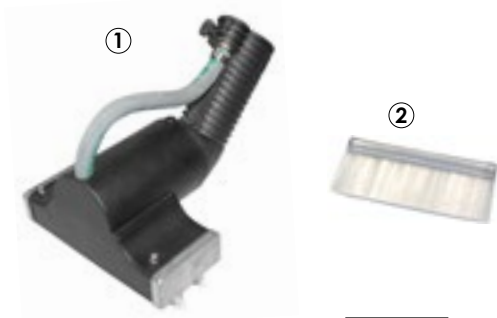

		code
1.	Radames floor tool L.140mm	7140074
2.	White nylon bristles strip	7013514



		code
1.	Steam Lance	51072GB
2.	Plastic tube with suction nozzle for turbo lance	510001B

SPECIAL PROFESSIONAL ACCESSORIES

Belt cleaner



Belt cleaner 60-100cm complete of 4m. vacuum hose
Belt cleaner 101-150cm complete of 4m. vacuum hose

** picture and prices are referred to the basic version; each enquiry will be followed by a customized project with eventual structure and price adjustment*

Vacuum hose to be specified:
for ASP450/ASP4400 - code TQ5004A / for ASP900C - code TQ5004I

	code
additional vacuum hose	RA32113
external switchbox complete of 4m. steam hose and 4m. electrical cable	QC00001
additional steam hose	TQVAPORE

Memory lance with stainless steel flexible tube 10 bar



code
1207012

**The nozzle for the lance has to be ordered separately based on the generator's power output, specify the power when you place the order.*

July lance with stainless steel flexible tube



code
7201080

for 10,8kW

Geyser Mop 1 movable L.220mm 10 bar



code
7002069

SPECIAL PROFESSIONAL ACCESSORIES

Mop July 10 bar

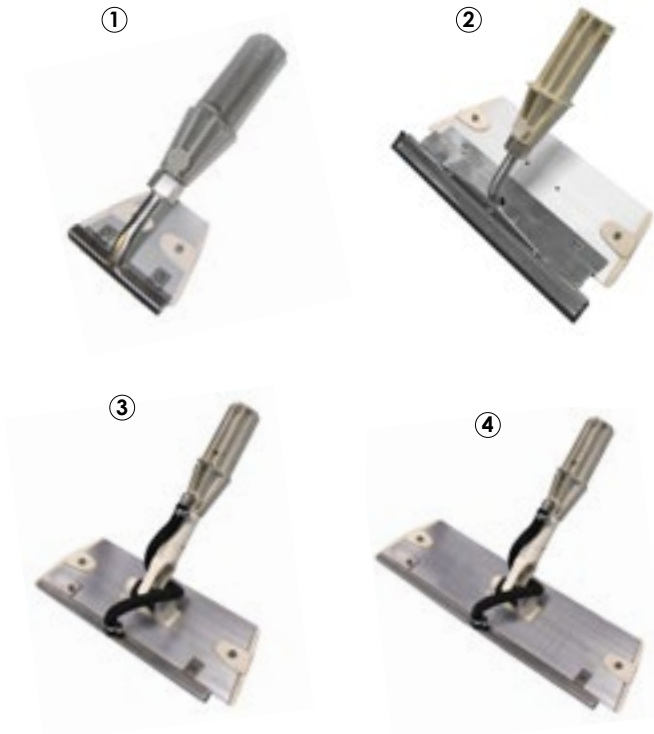

		code
1.	July mini mop L.90mm 6-10bar	7002001
2.	July mop L.250 6-10bar w/squeegee	7102514

		code
3.	July mop movable L.220mm 10bar	7002050
4.	July mop movable L.400mm 10bar	7004054

Fiber scrubbers for mops

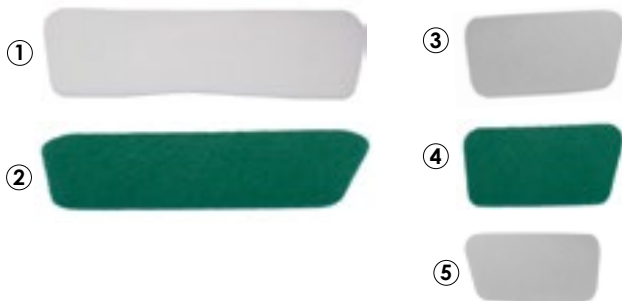

		code
1.	White fiber scrubber L.400mm	7000039
2.	Green fiber scrubber L.400mm	7000049
3.	White fiber scrubber L.240mm	7000059
4.	Green fiber scrubber L.240mm	7000069
5.	White fiber scrubber L.90mm	7000089

Water treatment systems



		code
1.	Water softener cartridge with resins for medium water consumption	FL00009
2.	Water softener with automatic regeneration of resins through sodium chlorite for high water consumption	FL00008



Duplex Cleaning Machines Pty Ltd
8/177 Beavers Rd NORTHCOTE VIC 3070
ABN 28 007 374 941

Freecall: 1800 622 770 | Ph: (03) 9482 4900 | Fax: (03) 9482 4940
Email: info@duplexcleaning.com.au
Web: www.duplexcleaning.com.au