

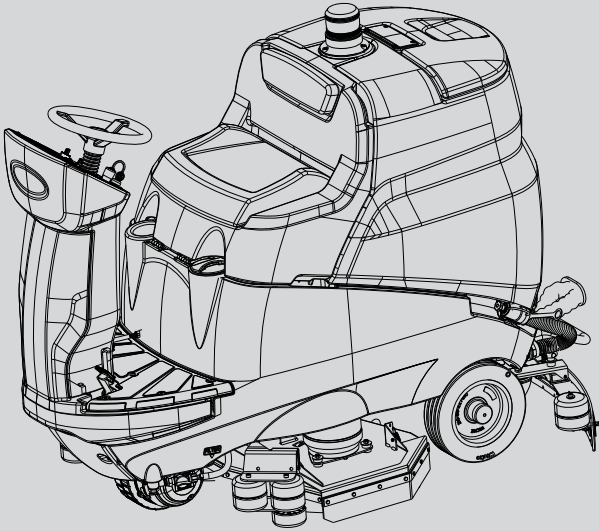

# T981

## BATTERY RIDER FLOOR SCRUBBER

OPERATOR'S MANUAL (EN)



### Model Part No.:

- LPTB03656 - SCRUBBER [T981, 90CM DISK, WITH BATTERY & CHARGER]
- LPTB03653 - SCRUBBER [T981, 75CM CYL, WITH BATTERY & CHARGER]
- LPTB03657 - SCRUBBER [T981, 90CM DISK, WITH BATTERY W/O CHARGER]
- LPTB03654 - SCRUBBER [T981, 75CM CYL, WITH BATTERY W/O CHARGER]
- LPTB03655 - SCRUBBER [T981, 90CM DISK, W/O BATTERY & CHARGER]
- LPTB03652 - SCRUBBER [T981, 75CM CYL, W/O BATTERY & CHARGER]



ANZ



To view, print or download  
the parts manual, visit:  
[www.tennantco.com/manuals](http://www.tennantco.com/manuals)

# TABLE OF CONTENTS

|   |           |
|---|-----------|
| <b>IMPORTANT SAFETY PRECAUTIONS</b> .....                 | <b>3</b>  |
| <b>SAFETY SYMBOLS</b> .....                               | <b>6</b>  |
| <b>TECHNICAL SPECIFICATIONS</b> .....                     | <b>7</b>  |
| <b>MACHINE DIMENSIONS</b> .....                           | <b>9</b>  |
| <b>GENERAL INFORMATION</b> .....                          | <b>10</b> |
| Purpose of this manual .....                              | 10        |
| Identifying the machine .....                             | 10        |
| Documentation provided with the machine .....             | 10        |
| <b>TECHNICAL INFORMATION</b> .....                        | <b>11</b> |
| General description .....                                 | 11        |
| Main parts of the machine.....                            | 11        |
| Control panel.....  | 12        |
| Accessories.....  | 12        |
| <b>HANDLING AND INSTALLATION</b> .....                    | <b>13</b> |
| Lifting and transporting the palletized machine.....      | 13        |
| Inspection on delivery .....                              | 13        |
| Unpacking .....   | 13        |
| Batteries .....   | 14        |
| Machine Battery Selection Setting .....                   | 14        |
| WET batteries, preparation: .....                         | 15        |
| Batteries: installation and connection.....               | 15        |
| Selection of battery charger .....                        | 16        |
| Preparing the battery charger .....                       | 16        |
| Battery charger settings .....                            | 17        |
| Fitting the squeegee.....                                 | 17        |
| Squeegee adjustment .....                                 | 17        |
| Fitting the Brush/Pad Holder.....                         | 18        |
| Fitting the brushes (Cylindrical Brush Model) .....       | 19        |
| Fitting the side brushes (Cylindrical Brush Model).....   | 20        |
| Filling the detergent tank.....                           | 21        |
| <b>PRACTICAL GUIDE FOR THE OPERATOR</b> .....             | <b>22</b> |
| Clothing and equipment .....                              | 22        |
| Before starting the machine .....                         | 22        |
| Preparing the machine for work .....                      | 22        |
| Working .....   | 22        |
| Service brake and parking brake .....                     | 24        |
| Double Scrubbing.....                                     | 25        |
| Picking up water (without scrubbing) .....                | 26        |
| During operation of the machine .....                     | 26        |
| Emergency stop button .....                               | 26        |
| Detergent solution tank empty indicator .....             | 27        |
| Dirty water tank full indicator .....                     | 27        |
| Battery charge indicator .....                            | 27        |
| Emptying the dirty water tank.....                        | 27        |
| Emptying the solution tank .....                          | 28        |
| Emptying the cylindrical brush debris bin.....            | 28        |
| Removing the the Brush/Pad Holder.....                    | 28        |
| Moving the machine when not in operation.....             | 29        |
| <b>MAINTENANCE INSTRUCTIONS</b> .....                     | <b>30</b> |
| Maintenance - General rules.....                          | 30        |
| Cleaning the suction motor air filter.....                | 30        |
| Cleaning the dirty water tank sensor.....                 | 30        |
| Cleaning the solution tank filter .....                   | 31        |
| Fuses: .....  | 31        |
| Battery maintenance .....                                 | 31        |
| Checking the electrolyte level of WET batteries.....      | 32        |
| Recharging the batteries.....                             | 32        |
| Battery: removal.....                                     | 33        |
| Replacement of Brushes and Pads.....                      | 33        |
| Replacing the squeegee blades.....                        | 34        |
| Cylindrical Brush Model side brushes wear adjustment..... | 34        |
| Machine Jacking .....                                     | 34        |
| Periodic checks .....                                     | 35        |
| <b>PERIODS OF INACTIVITY</b> .....                        | <b>35</b> |
| <b>TROUBLESHOOTING</b> .....                              | <b>36</b> |
| <b>ALARMS/WARNINGS DISPLAYED</b> .....                    | <b>37</b> |
| <b>DRIVE WHEEL PCB ALARMS</b> .....                       | <b>38</b> |
| <b>USER MENU</b> .....                                    | <b>39</b> |
| <b>RECOMMENDED SPARE PARTS</b> .....                      | <b>40</b> |

## **IMPORTANT SAFETY PRECAUTIONS**

Parts of the text requiring special attention are printed in bold and preceded by the symbols illustrated and described below.



### **! DANGER:**

**Indicates the need for care in order to avoid serious consequences that could lead to the death of personnel, or to situations representing a possible health and safety hazard.**

### **! ATTENTION:**

**Indicates the need for care in order to avoid serious consequences that could involve harm being done to the machine or to the workplace, or lead to economic losses.**



**! DANGER: If lead-acid (WET) batteries are installed in the machine, keep sparks, flames and smoking materials away from the batteries. Explosive gases can escape during normal use, particularly when recharging the batteries.**



**! DANGER: If lead-acid (WET) batteries are installed in the machine, charging the batteries produces highly explosive hydrogen gas. Keep the operator seat tilted toward the steering wheel throughout the battery charging cycle and carry out this procedure only in well-ventilated areas, away from naked flames.**



**! DANGER: Never use the machine to clean up flammable or explosive liquids (e.g. petrol, fuel oil, etc.), acids or solvents (e.g. paint solvents, acetone etc.) even if diluted.**



**! DANGER: Never pick up burning or incandescent objects.**



**! DANGER: This machine is not to be used on floors where hazardous coatings / finishes / materials exist (intended use statement).**



**! DANGER: Do not spray flammable liquids.**

### **Do not use the machine:**

- without having read the operating and maintenance manual.
- without having been trained in its use.
- without having been specifically entrusted with its use.
- if legally under age.
- if the machine is not working properly.
- in places without adequate lighting.
- in explosive environments.
- on public roads.
- outdoors: the machine must be used only indoors.
- where there is dirt that can be harmful to health (dust, gas, etc.).
- where there is danger of falling objects.
- in areas that are too dark to safely see the controls or operate the machine.

### **Clothing and equipment:**

- Wear safety shoes with non-slip soles.
- Wear protective eyewear or visor and safety garments.
- Depending on the surface being cleaned and on the environment, the protective measures necessary for atomized sprays include respiratory masks with class FFP2 or equivalent or higher protection.

### **Before starting the machine:**

- Check that the machine is not damaged.
- Check the operation of the brake.
- Check that all safety devices are in place and operating correctly.

### **When using the machine:**

- The machine must be operated by one person only.
- Be careful to follow the safety regulations of the particular workplace regarding wet floors. When necessary, place safety signs on the wet floor while using the machine
- Park the machine on a level surface
- Do not allow children to play on or near the machine.
- Consider the type of building in which the machine is to be used (e.g. pharmaceutical/chemical plant, hospital, etc.) and observe the internal safety regulations and conditions to the letter.
- The machine must not be used for purposes other than those expressly intended.
- The machine is intended for commercial use, for example in hotels, schools, hospitals, factories, shops, offices and business premises generally. Do not use for other purposes.
- Keep all parts of body inside operator station while machine is moving.
- The machine can be used only indoors.
- The machine must be stored only indoors.
- Do not allow the machine to be used as a toy.
- The machine is not designed to tow or be towed.
- Never rest objects of any significant weight on the machine, for whatever reason.
- Never obstruct the air inlet and release vents.
- Never remove, modify or circumvent safety devices.
- The machine has been designed for use with detergents

supplied or recommended by the manufacturer. The use of other detergents or chemicals may jeopardise the safety of the appliance.

- When using floor cleaning products, follow the instructions and warnings on the labels of the bottles.
- Do not use detergents that may produce dangerous reactions, vapours, heat, etc.
- During use, atomized spray may form. Inhaling this atomized spray can be harmful to health.
- Work providers must conduct a risk assessment in order to specify the necessary protective measures relating to the formation of atomized sprays, depending on the surface being cleaned and the environment. Masks with class FFP2 or equivalent or higher protection are suitable for protecting against the inhalation of atomized spray.
- Keep hands away from moving parts.
- In the case of malfunction and/or faulty operation, turn the machine off immediately (disconnect from the batteries/ mains power supply) and do not tamper with it; contact a service centre approved by the manufacturer.
- The machine is designed to operate in temperatures between +4°C / 39.2°F and +40°C / 104°F. It can be stored in temperatures between +0°C / 32°F and +50°C / 122°F when not in use.
- The machine is designed to operate at relative humidity levels between 30% and 95%.
- The machine can operate at altitudes up to 2000 m / 6561.68 ft maximum.
- Do not use the machine to clean surfaces on slopes or gradients steeper than indicated on the data plate.
- Do not operate the machine on slopes or gradients steeper than indicated on the data plate.
- When using the machine on gentle gradients, do not move transversely across the slope, but keep the machine on a line parallel to the direction of the incline, manoeuvring carefully and without making U-turns.
- The machine must not be used by persons (including children) with diminished physical, sensory or mental capabilities, or lack of experience and knowledge, unless they are supervised by a person responsible for their safety and have received instruction in the use of the machine.
- Never use the machine to transport people or goods or for towing.
- Do not wear jewellery, watches, ties or other items.
- The operator must always use Personal Protective Equip-

ment: protective apron or overalls, non-slip waterproof shoes, rubber gloves, protective eyewear and ear defenders, and mask for protection of the respiratory airways.

#### **Before leaving the machine or before maintenance:**

- Park the machine on a flat, level surface.
- Turn off the machine and remove the ignition key.

#### **When performing maintenance:**

- All operations must be carried out in conditions guaranteeing adequate visibility and lighting.
- Isolate the machine from its power source by disconnecting the batteries.
- The operator must always use Personal Protective Equipment: protective apron or overalls, non-slip waterproof shoes, rubber gloves, protective eyewear and ear defenders, and mask for protection of the respiratory airways.
- Do not wear jewellery, watches, ties or other items.
- Do not push or tow the machine without an operator sitting in the driving seat and able to control the steering wheel.
- Protect the batteries from impurities such as metal dust.
- Take care when handling battery acid, and avoid contact. In the event of battery fluid leakage, do not touch the fluid and observe the following precautions: Contact with the skin can cause irritation; wash with soap and water. Inhalation of vapours can cause irritation to the airways; stay out in the open air and consult a doctor. Contact with the eyes can cause irritation; wash the eyes immediately, flooding with water for at least 15 minutes, and consult a doctor.
- Never rest tools on the batteries as they could cause short circuits leading to explosions.
- Always use the battery charger accompanying the machine (if supplied), or if not, a product with specifications as recommended in the technical data.
- Installation of the battery should be entrusted to a TENNANT approved service technician.
- Inspect the power cable of the battery charger periodically to ensure that it is not damaged; in the event of damage being discovered, the appliance cannot be used. Replacement of the cable should be entrusted to a TENNANT approved service technician. Detach both connections of the battery charger (AC side and DC side).
- Do not tug at the battery charger cable to disconnect it from the socket: grip the plug firmly and pull.
- Never wash the machine with water jets.
- Cleaning and maintenance operations that can be performed by the user must not be entrusted to children unless under supervision.
- All repairs must be carried out by a TENNANT approved service technician.
- Use only original accessories and spare parts supplied exclusively by the manufacturer, as only these are able to

guarantee safe and troublefree operation of the machine.







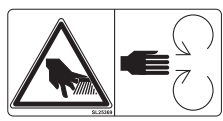

- Never use parts removed from other machines or from other kits.

**When the machine is to be loaded onto or unloaded from a vehicle:**

- Empty the tanks before loading the machine.
- Raise the scrub head and remove the squeegee from the machine.
- Do not drive the machine on a slippery ramp.
- Take particular care when operating the machine on ramps.
- Turn off the machine and remove the ignition key.
- Lock the wheels of the machine.
- Use straps to anchor the machine.

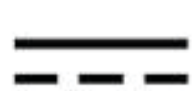
**KEEP THESE INSTRUCTIONS SAFE.**

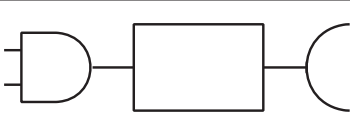
# SAFETY SYMBOLS

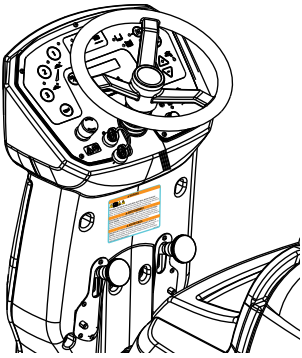
|  |   |
|--|---|
|   | <p>WARNING! RISK OF CUTTING</p>   |
|   | <p>WARNING! RISK OF ABRASION</p>  |
|   | <p>MAXIMUM SLOPE</p>  |
|   | <p>OPERATOR MANUAL, INSTRUCTIONS FOR USE</p>  |
|   | <p>READ THE OPERATOR'S MANUAL</p>   |
|   | <p>DIRECT CURRENT SYMBOL</p>  |
|   | <p>INSULATION CLASS: THIS CLASSIFICATION ONLY APPLIES TO BATTERY POWERED MACHINES.</p>  |
|   | <p>EXTERNAL BATTERY CHARGER CONNECTION POINT.</p>   |
|   | <p>LIFTING POINTS ON THE MACHINE.</p>   |
| <div data-bbox="140 1496 483 1704" style="border: 1px solid black; padding: 5px;"> <p style="text-align: center;"><b>▲ WARNING</b></p> <p><b>TO REDUCE THE RISK OF FIRE, EXPLOSION, ELECTRICAL SHOCK OR INJURY:</b><br/>         • Read manual before operating machine. • Do not use outdoors. Store indoors. • Do not use or pick up flammable materials. • Do not use near flammable liquids, vapors or combustible dusts. • Keep sparks and open flame away from batteries. • Do not charge batteries with damaged cord. • Remove battery before servicing machine.</p> <p style="text-align: center;"><b>▲ AVERTISSEMENT</b></p> <p><b>POUR RÉDUIRE LES RISQUES D'INCENDIE, L'EXPLOSION, DE CHOC ÉLECTRIQUE OU DE LÈSSURE:</b><br/>         • Lisez le manuel avant d'utiliser la machine. • Ne pas utiliser à l'extérieur. Entreposer à l'intérieur. • Ne pas utiliser à proximité des matériaux inflammables. • Ne pas utiliser à proximité de liquides, vapeurs ou poussières combustibles inflammables. • Évitez les étincelles et les flammes nues près des batteries. • Ne chargez pas les batteries avec un cordon endommagé. • Retirez la batterie avant de l'entretenir la machine.</p> <p style="text-align: center;"><b>▲ ADVERTENCIA</b></p> <p><b>PARA REDUCIR EL RIESGO DE INCENDIO, EXPLOSION, CHOQUE ELECTRICO, O LESIONES:</b><br/>         • Lea el manual antes de utilizar la máquina. • No utilizar en exteriores. Almacenar en el interior. • No utilizar ni recoger materiales inflamables. • No use cerca de líquidos inflamables, vapores o polvos combustibles inflamables. • Mantenga las chispas y las flamas abiertas lejos de las baterías. • No cargue las baterías si el cable está dañado. • Retire la batería antes de reparar la máquina.</p> <p style="text-align: right; font-size: small;">E12111103</p> </div>  | <p>SAFETY LABEL. THE SAFETY LABEL IS MOUNTED ON THE MACHINE IN THE LOCATION INDICATED. REPLACE THE LABEL IF BECOMES DAMAGED OR ILLEGIBLE.</p> |

# TECHNICAL SPECIFICATIONS

|  |          |                     | 90cm Disk              | 75cm Cylindrical Brush  |
|--|----------|---------------------|------------------------|-------------------------|
| Cleaning width   |          | mm                  | 900                    | 750                     |
|  |          | inch                | 36                     | 30                      |
| Squeegee width   |          | mm                  | 1100                   | 1010                    |
|  |          | inch                | 43.3                   | 39.76                   |
| Cleaning capacity per hour                             |          | m <sup>2</sup> /h   | 5300                   | 4300                    |
|  |          | ft <sup>2</sup> /h  | 57048.72               | 46284.81                |
| Number of brushes                                      |          | no.                 | 2                      | 2                       |
| Brush diameter   |          | mm                  | 460                    | 150x750                 |
|  |          | inch                | 18.11                  | 5.9x29.52               |
| Maximum brush pressure                                 |          | kg                  | 100                    | 50                      |
|  |          | lbs                 | 220.46                 | 110.23                  |
| Brush rotation speed                                   |          | rpm                 | 200                    | 1000                    |
| Brush motor power                                      |          | W                   | 400x2                  | 1000                    |
|  |          | HP                  | 0.53x2                 | 1.34                    |
| Drive motor power                                      |          | W                   | 560                    | 560                     |
|  |          | HP                  | 0.75                   | 0.75                    |
| Suction motor power                                    |          | W                   | 672                    | 672                     |
|  |          | HP                  | 0.9                    | 0.9                     |
| Machine power (P <sub>M</sub> )                        |          | W                   | 2592                   | 2592                    |
|  |          | HP                  | 3.47                   | 3.47                    |
| Maximum speed  |          | km/h                | 6                      | 6                       |
|  |          | mph                 | 3.72                   | 3.72                    |
| Solution tank  |          | l                   | 125                    | 125                     |
|  |          | gal                 | 33.02                  | 33.02                   |
| Dirty water tank                                       |          | l                   | 135                    | 135                     |
|  |          | gal                 | 35.66                  | 35.66                   |
| Front wheel diameter                                   |          | mm                  | 300                    | 300                     |
|  |          | inch                | 11.81                  | 11.81                   |
| Rear wheel diameter                                    |          | mm                  | 300                    | 300                     |
|  |          | inch                | 11.81                  | 11.81                   |
| Negotiable gradient                                    |          |                     | 16% / 9°               | 16% / 9°                |
| Gross weight (GVW) with heaviest battery               |          | kg                  | 917                    | 936                     |
|  |          | lbs                 | 2021.64                | 2063.53                 |
| Weight of the machine in transit without batteries     |          | kg                  | 292                    | 300                     |
|  |          | lbs                 | 643.75                 | 661.39                  |
| Weight of the machine in transit with heaviest battery |          | kg                  | 707                    | 715                     |
|  |          | lbs                 | 1558.67                | 1576.31                 |
| Machine voltage V <sub>M</sub>                         |          | V                   | 36                     | 36                      |
| Number of batteries                                    | GEL/AGM  | no.                 | 6                      | 6                       |
| Individual battery capacity                            |          | Ah (20h)            | 270                    | 270                     |
| Individual battery weight                              |          | kg                  | 48,2                   | 48,2                    |
|  |          | lbs                 | 106.3                  | 106.3                   |
| Number of batteries                                    | WET-ACID | no.                 | 6                      | 6                       |
| Individual battery capacity                            |          | Ah (20h)            | 360                    | 360                     |
| Individual battery weight                              |          | kg                  | 44,5                   | 44,5                    |
|  | lbs      | 98                  | 98                     |                         |
| Supply voltage (battery recharge)                      |          | V                   | 36 dc                  | 36 dc                   |
| Max current (battery recharge)                         |          | A                   | 40                     | 40                      |
| Machine dimensions                                     |          | mm<br>X<br>Y<br>Z   | 1720<br>1100<br>1360   | 1810<br>1050<br>1360    |
|  |          | inch<br>X<br>Y<br>Z | 67.71<br>43.3<br>53.54 | 71.25<br>41.33<br>53.54 |

|  |                           |                         |                         |
|--|---------------------------|-------------------------|-------------------------|
| Battery compartment dimensions (length, width, height)                       | mm                        | 620<br>530<br>440       | 620<br>530<br>440       |
|  | inch                      | 24.4<br>20.86<br>17.32  | 24.4<br>20.86<br>17.32  |
| Machine dimensions without squeegee (length, width, height)                  | mm                        | 2000<br>1280<br>1670    | 2000<br>1280<br>1670    |
|  | inch                      | 78.74<br>50.39<br>65.74 | 78.74<br>50.39<br>65.74 |
| Sound pressure - Annex DD (Emission of acoustical noise) EN 60335-2-72: 2012 | LpA<br>(dBA)              | 72                      | 72                      |
| Measurement uncertainty  | K<br>(dBA)                | 3                       | 3                       |
| Vibration level (hand) - IEC 60335-2-72                                      | ahv<br>m/sec <sup>2</sup> | ≤2,5                    | ≤2,5                    |
| Vibration level (body) - IEC 60335-2-72                                      | HBV<br>m/sec <sup>2</sup> | ≤0,5                    | ≤0,5                    |
| Maximum water and detergent temperature                                      | °C                        | 55                      | 55                      |
| IP degree  | IP                        | IPX3                    | IPX3                    |

Gross weight (GVW): maximum permissible weight with the machine fully loaded and ready for use. The gross weight of the machine includes the detergent solution tank full of clean water, empty dirty water tank, empty dust bags, the hopper filled to its rated capacity, the largest recommended batteries and all accessories such as cables, hoses, detergent, mops and brushes.

Transported weight: the weight of the machine including batteries, but excluding optionals (for example, the operator's cabin, FOPS (Falling Object Protective Structure), second and third side brushes and front brush attachment), fresh water (in the case of scrubbers or combination machines) and the weight of a standard operator (75 kg).

Data subject to changes without prior warning

V, I: charging / supply values

$V_M$ ,  $P_M$ : machine in average operating conditions (all functions active)

# MACHINE DIMENSIONS

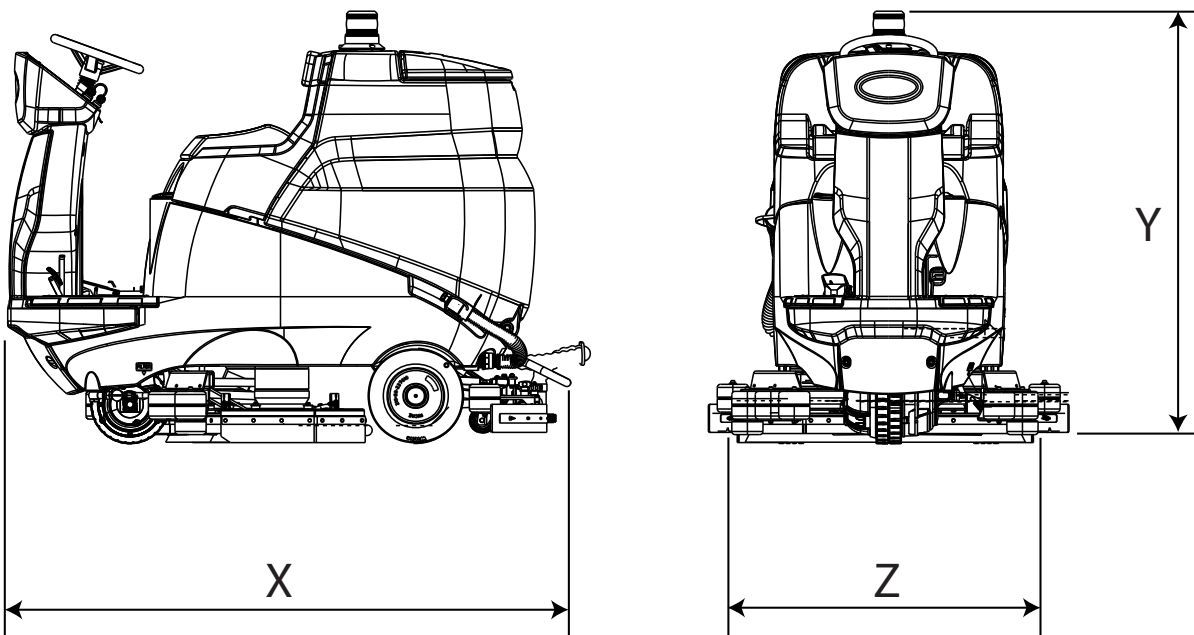

X-Y-Z: See “TECHNICAL SPECIFICATIONS” table

# GENERAL INFORMATION

## Purpose of this manual

This manual has been written by the Manufacturer and is an integral part of the [machine](#)<sup>1</sup>.

It defines the purpose for which the machine has been designed and constructed and contains all the information required by [operators](#)<sup>2</sup>.

In addition to this manual, which contains information for operators, other publications are available providing specific information for [maintenance personnel](#)<sup>3</sup>.

The terms “right” and “left”, “clockwise” and “anti-clockwise” refer to the forward movement of the machine.

Constant compliance with the instructions provided in this manual guarantees the safety of the operator and the machine, ensures low running costs and high quality results and extends the working life of the machine. Failure to follow these instructions may lead to injury to the operator or damage to the machine, floor and environment.

Consult the table of contents at the beginning of the manual to find the section of interest without delay.

**Although your machine may differ appreciably from the illustrations in this document, the correctness and validity of the instructions contained in this manual are guaranteed.**

## Identifying the machine

The nameplate provides the following information:

- Name of manufacturer.
- Model.
- Serial number.
- Year of manufacture.
- Power supply voltage (charging/supply value).
- Current intensity (maximum charge level, in line as far as possible with the value indicated by the battery manufacturer).
- Gross weight.
- IP degree of protection.
- Machine voltage (in average operating conditions).
- Machine power (in average operating conditions).
- Maximum negotiable gradient.

## Documentation provided with the machine

- User manual;
- Warranty Reply Card;
- Quick Guide;
- Machine battery selection setting instructions;

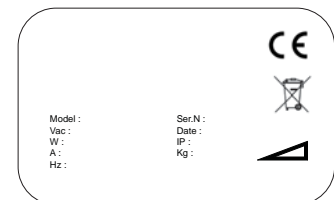

<sup>1</sup> The definition "machine" replaces the trade name covered by this manual.

<sup>2</sup> Persons responsible for using the machine without performing any operations requiring precise technical skills.

<sup>3</sup> Persons with experience, technical training and a knowledge of legislation and standards, able to perform all the necessary operations and to recognise and avoid possible risks in handling, installation, use and maintenance of this machine.

# TECHNICAL INFORMATION

## General description

This machine is a scrubber dryer for washing and drying flat, horizontal, smooth or moderately rough, even and obstacle free floors in civil and industrial premises.

The scrubber dryer spreads a solution of water and detergent in the correct concentration on the floor and then scrubs it to remove the dirt. By carefully choosing the detergent and brushes (or abrasive disks) from the wide range of accessories available, the machine can be adapted to a wide range of combinations of types of floor and dirt.

The machine incorporates a wet vacuuming system which dries the floor immediately after washing. The drying action is produced by the suction motor, which generates a partial vacuum in the dirty water tank. The squeegee is connected to the tank, and collects the dirty water.

## Main parts of the machine

The main parts of the machine are listed below:

1. Dirty water tank.
2. Solution tank.
3. Control panel.
4. Head assembly.
5. Squeegee.
6. Dirty water tank drain hose.
7. Dirty water tank lid.
8. Driver seat.
9. Battery compartment.
10. Steering wheel.
11. Solution tank drain hose.
12. Squeegee hose.
13. Accelerator pedal.
14. Solution tank filler.
15. Service and parking brake pedal.
16. Side brushes (Cylindrical Brush model).
17. Side brushes operating levers (Cylindrical Brush model).

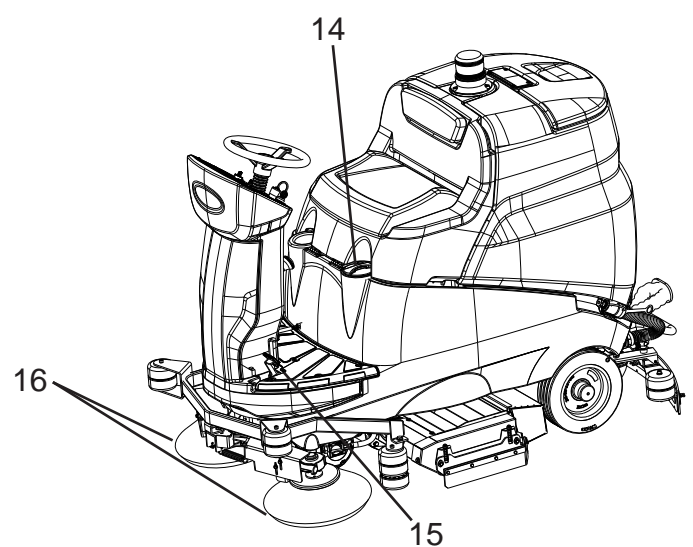
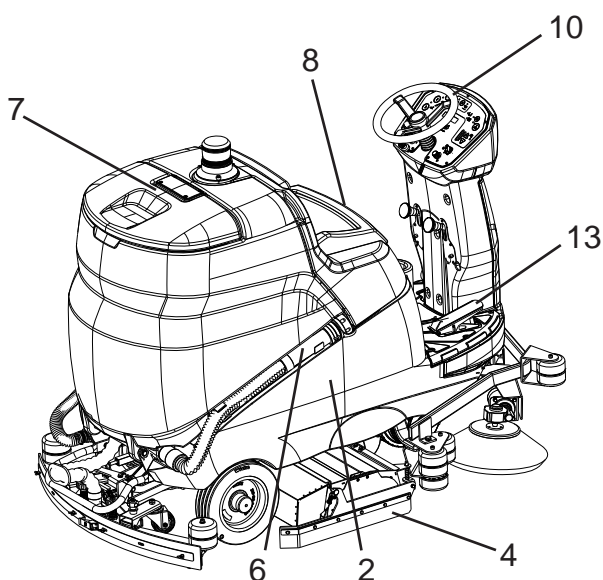
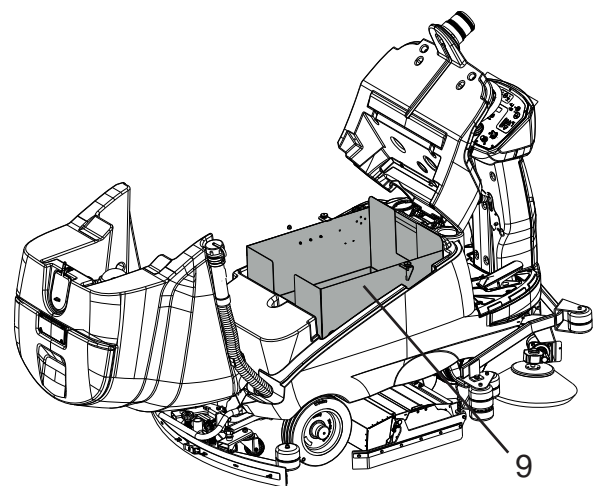
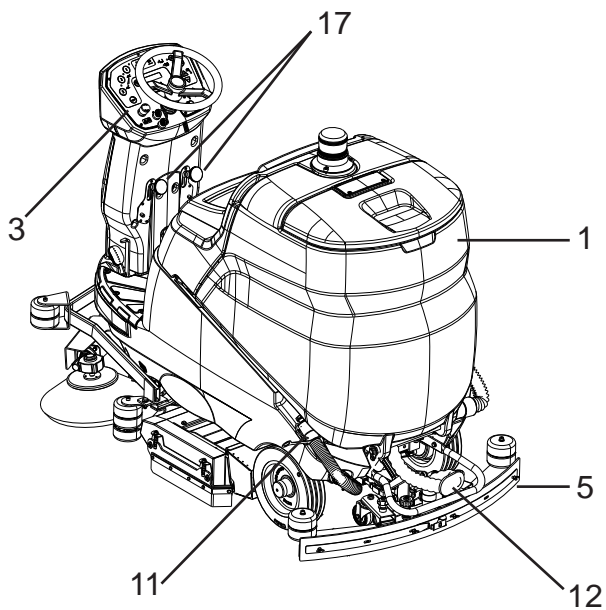

## Control panel

The machine has the following controls and indicator lights:

18. Attach/release brush button (disk brushes only) that enables the automatic brush attachment or release.
19. Main switch/ignition switch: connects and disconnects electrical power to and from all functions of the machine.
20. Emergency stop button: acts as a safety device.
21. Speed potentiometer: regulates the maximum speed of the machine forwards and backwards.
22. Direction selector switch, to set movement of the machine to forwards or reverse.
23. Buttons “+” and “-”, pressing these buttons determines the amount of flow delivered.
24. Display, showing: Battery voltage (Volt), Alarm codes and Hour counter.
25. Horn button.
26. Suction button: enables/disables the suction motor.
27. Brush button: enables/disables operation of the brush head.
28. Detergent tank level indicator: the LED comes on when there is no longer sufficient water in the detergent tank.
29. Dirty water tank level indicator: when the dirty water tank is full, the LED comes on.

30. Work program buttons (AUTOMATIC MACHINE OPERATION): buttons used to set the machine's work program:

- 1, light intensity cleaning program for smooth floors, not excessively soiled.
- 2, medium intensity cleaning program for smooth floors, noticeably soiled.
- 3, high intensity cleaning program for rough floors (cement, etc.) soiled with stubborn dirt.

31. Drive wheel LED status indicator.

32. Programming button: press this button to scroll the parameters that can be set in the machine's software.

## Accessories

See Recommended Spare Parts List

- Bristle brushes/rollers: for washing delicate floors and polishing.
- Polypropylene brushes/rollers: for normal floor washing.
- Tynex brushes/rollers: for removing accumulated stubborn dirt on rugged floors.
- Pad Holder Disk: This enables the use of the various cleaning pad types.
- WET and GEL Batteries.
- Off-Board Battery Chargers.

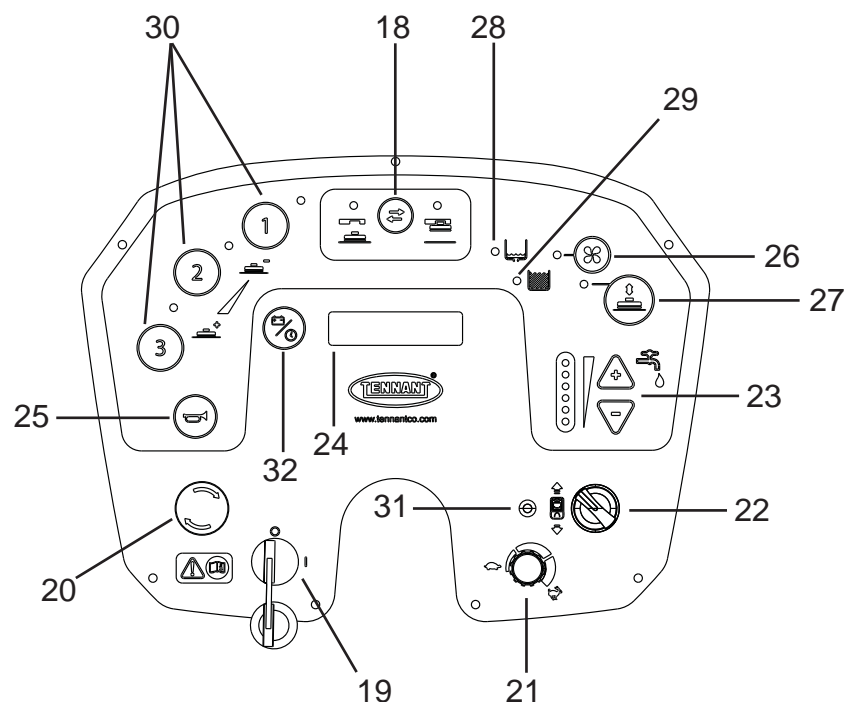

# HANDLING AND INSTALLATION

## Lifting and transporting the palletized machine

**! ATTENTION:** during all lifting operations, make sure the palletized machine is firmly secured to prevent it tipping over or being accidentally dropped.

The machine must be loaded onto/unloaded from vehicles in areas with adequate lighting.

The machine is packaged on a wooden pallet by the Manufacturer. It must be loaded on to the transporting vehicle using suitable equipment (see Directive 2006/42/EEC and subsequent amendments and/or additions). At destination, it must be unloaded using similar means.

The palletized body of the machine can be lifted only with the aid of a fork lift truck. Handle with care to avoid impact and ensure the machine is not overturned.

## Inspection on delivery

When the carrier delivers the machine, make sure the packaging and machine are both whole and undamaged. If the machine is damaged, make sure the carrier is aware of the damage and before accepting the goods, reserve the right (in writing) to request compensation for the damage.

## Unpacking

**! DANGER:** when unpacking the machine, the operator must wear suitable Personal Protection Equipment (gloves, eyewear, etc.) to limit the risk of injury.

When unpacking the machine, proceed as follows:

- Cut and remove the plastic straps using scissors or nippers;
- Remove the cardboard packaging;
- Remove the bags placed inside the battery compartment and check the contents: user manual; Warranty Reply Card; quick guide; instructions for setting up the battery type on the machine; battery bridges with terminals; 1 x connector for battery charger; 2 x hex wrench;
- Remove the metal brackets securing the front/rear wheels and the machine chassis to the pallet base.

- Release the parking brake by pressing the lever next to the pedal
- Before unpacking the machine, check that the head assembly is raised.

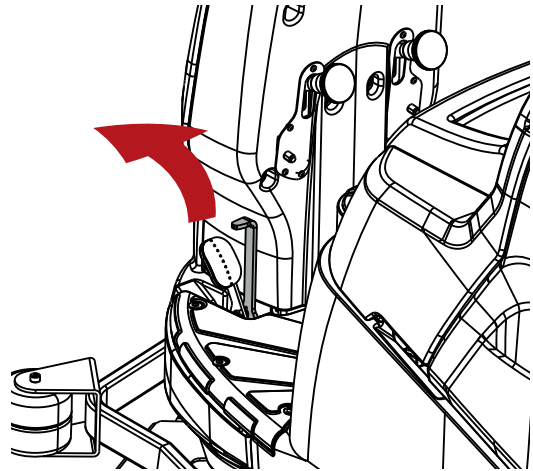

- Using a ramp, push the machine off the pallet in the reversing direction. The machine must not be lifted.

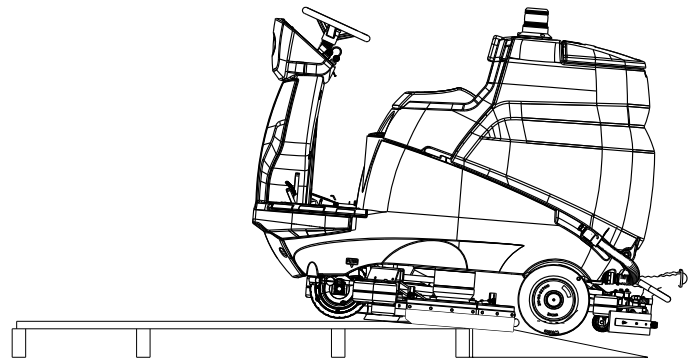

- Unpack the brushes from their packaging.
- Clean the outside of the machine, taking care to observe safety regulations.

Once the machine is clear of the packaging, proceed to install the batteries (refer to section "**Batteries: installation and connection**").

The various items of packaging can be kept, if so desired, as these can be reused to protect the machine in the event of it being moved to a different site or sent to a repair workshop.

If not retained, the packaging must be disposed of in compliance with current regulations.

## Batteries

### ! ATTENTION: do not use NON-rechargeable batteries

Two different types of battery can be installed on these machines:

Leak-proof tubular batteries (WET): the electrolyte level must be checked regularly.

GEL or AGM batteries: this type of battery requires no maintenance.

The technical specifications of the battery must correspond to those listed in the section on the “**Technical specifications**” of the machine. The use of heavier batteries could seriously jeopardize manoeuvrability and lead to the drive motor overheating. Lighter batteries of lower capacity, on the other hand, will need to be charged more frequently.

### Machine Battery Selection Setting

**! ATTENTION:** where machines are shipped without batteries, the machine is factory set for wet lead-acid batteries as the default configuration.

Depending on the type of battery selected (wet lead-acid or sealed gel / AGM), the battery parameters of the machine **MUST** be adjusted if different from the factory setting.

#### ! NOTICE

Enter the type of battery installed in the machine software settings.

Follow the instructions below to adjust the machine logic settings for the type of battery installed.

- Turn the ignition key to switch the machine off.

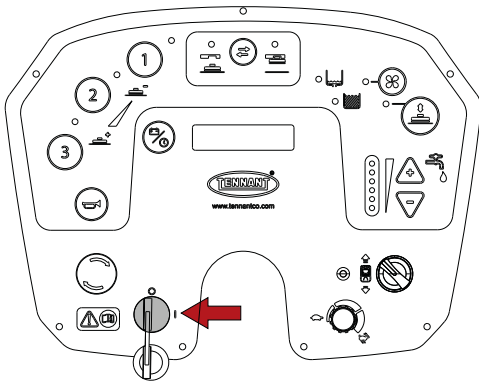

- Press buttons “1 and 3” at the same time, then switch the machine on by turning the ignition key.

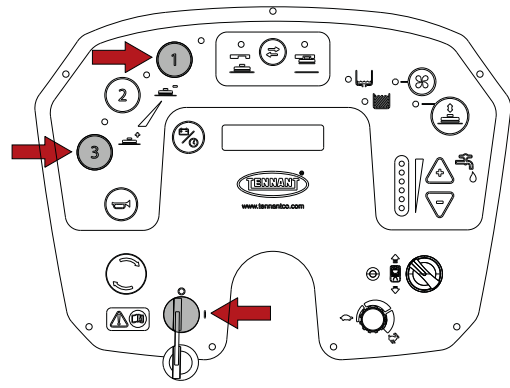

- Press the programming button three times, the message “GEL battery” will appear on the display.

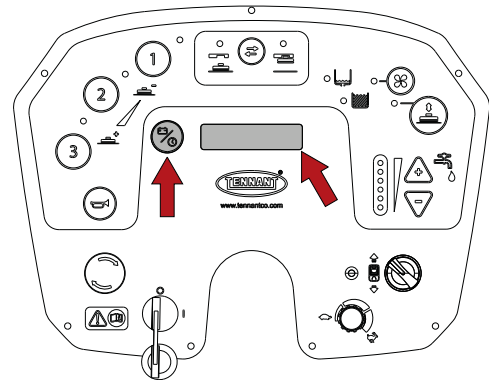

- Select the type of batteries installed using the “+” or “-” button: “ACID battery” or “GEL battery”.

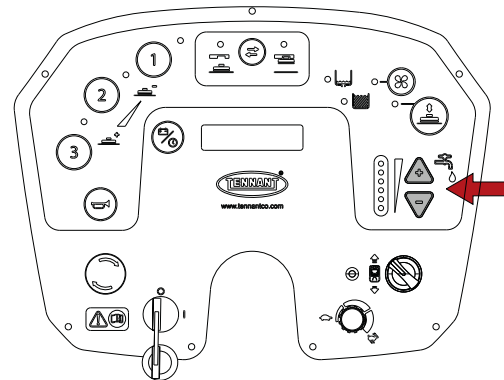

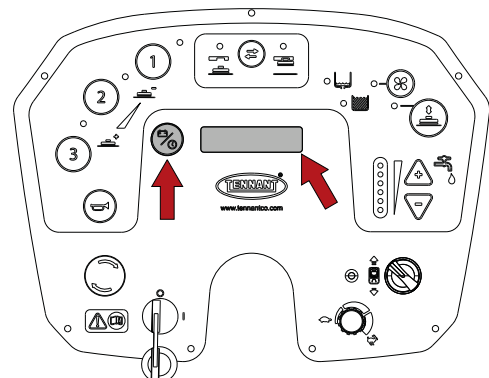

- Store the parameter by pressing and holding the programming button until the display shows the battery voltage value.



## WET batteries, preparation:

 **! DANGER:** The installation and connection/removal of the batteries must be entrusted to a TENNANT-approved service technician (referred to hereinafter as skilled technician).

 **! DANGER:** during installation of the batteries or any type of battery maintenance, the skilled technician must wear the Personal Protective Equipment (gloves, eyewear, overalls, etc.) needed to limit the risk of accidents. Keep away from naked flames, do not short circuit the battery poles, do not generate sparks and do not smoke.

 **! DANGER:** in the event of battery fluid leakage, do not touch the fluid and observe the following precautions:  
Contact with the skin can cause irritation; wash with soap and water.  
Inhalation of vapours can cause irritation to the airways; stay out in the open air and consult a doctor.  
Contact with eyes can cause irritation, wash eyes immediately and thoroughly with water for at least 15 minutes; consult a doctor.

## Batteries: installation and connection

 **! DANGER:** during installation of the batteries or any type of battery maintenance, the skilled technician must be provided with the necessary personal protection devices (gloves, goggles, overalls, etc.) to limit the risk of accidents. Keep away from naked flames, do not short circuit the battery poles, do not generate sparks and do not smoke.

 **! DANGER:** in the event of battery fluid leakage, do not touch the fluid and observe the following precautions:  
Contact with the skin can cause irritation; wash with soap and water.  
Inhalation of vapours can cause irritation to the airways; stay out in the open air and consult a doctor.  
Contact with eyes may cause irritation, wash eyes immediately and thoroughly with water for at least 15 minutes; consult a doctor.

**! ATTENTION:** the operation of installing and connecting the batteries must be carried out by qualified personnel.

**! ATTENTION:** before carrying out the operations described below, stop on a flat and level surface, switch off the machine, remove the ignition key and apply the parking brake.

 **! DANGER:** make certain the terminals marked with the “+” symbol are connected to the positive poles of the battery. Do not check the battery charge by sparking.

Tilt the seat forward and the tank backwards, then place the batteries in the compartment, positioning them as indicated by the drawing on the battery box.

Connect the wiring terminals to the battery poles, tighten and cover with Vaseline.

Close the tank into the working position.

When using the machine, follow the instructions below.

## Selection of battery charger

**! ATTENTION: check that the battery charger is compatible with the batteries being charged.**

Tubular lead-acid (wet) batteries: an electronic battery charger is recommended. In any event, contact the manufacturer and consult the manual to confirm that the external battery charger is suitable.

Gel or AGM batteries: use a charger intended specifically for this type of battery.

## Preparing the battery charger

**! ATTENTION: authorized service technician required to perform this procedure.**

When using a battery charger not provided with the machine, it must be fitted with the connector included in the machine equipment package.

The connector supplied for the external battery charger is suitable for cables with maximum cross-section 16 mm<sup>2</sup>

Proceed as follows to fit the connector:

remove around 13 mm of the protective sheath from the red and black conductors of the battery charger cable; attach the ends to the contacts of the connector and squeeze forcibly with suitable crimping pliers; make certain the polarity is correct (red + black -) when attaching the wires to the connector.

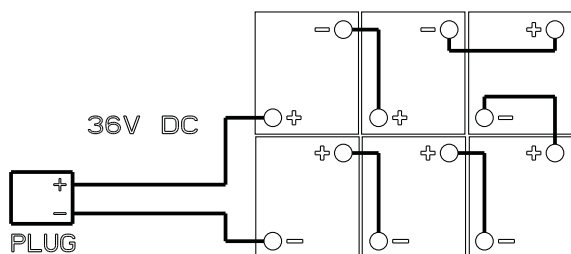
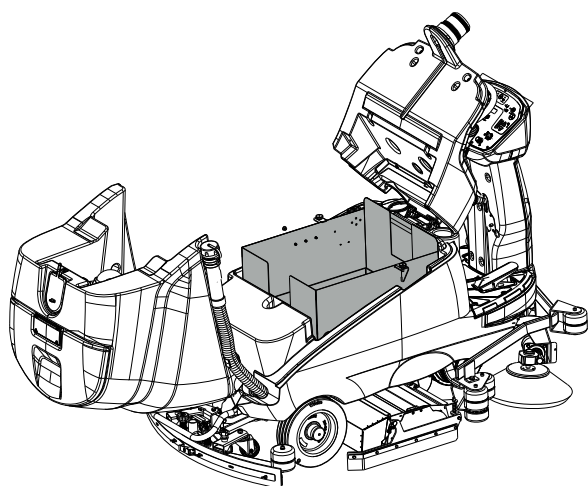

## Battery charger settings

**! ATTENTION:** where machines are shipped without batteries, the machine is factory set for wet lead-acid batteries as the default configuration.

Depending on the type of batteries installed, make sure the battery charger is properly set.

Failure to observe these instructions could result in damage to the battery. Depending on the type of battery selected (wet lead-acid or sealed gel / AGM), the battery parameters of the machine **MUST** be adjusted if different from the factory setting. For directions, see the section "Batteries".

## Fitting the squeegee

**! ATTENTION:** before carrying out the operations described below, stop on a flat and level surface, switch off the machine, remove the ignition key and apply the parking brake.

- Loosen the two knobs.
- Locate the two threaded pins in the slots on the support.

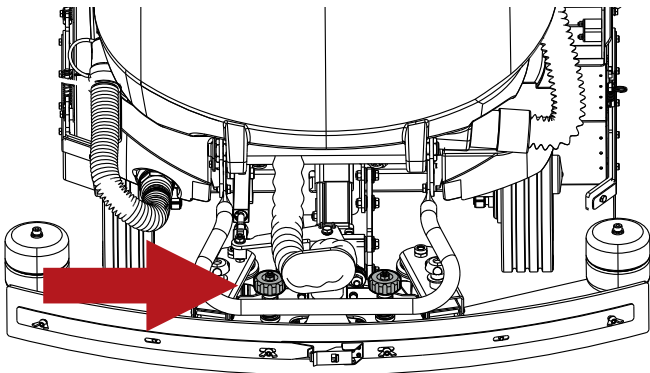

- Connect the suction hose to the squeegee, bending it to the position as illustrated.
- Tighten the two knobs.

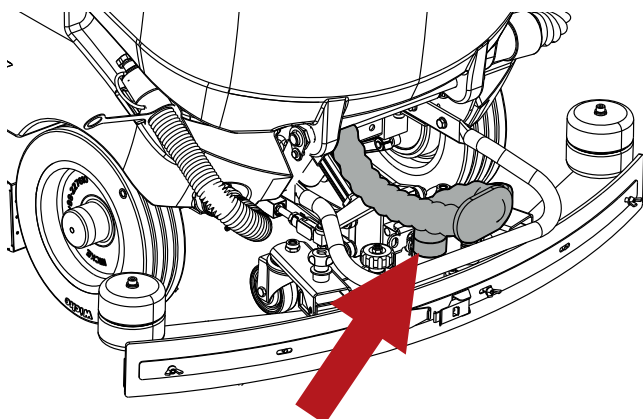

The position of the squeegee is factory-set. Should the squeegee blade require adjustment, refer to the section "Squeegee adjustment".

## Squeegee adjustment

**! ATTENTION:** before carrying out the operations described below, stop on a flat and level surface, switch off the machine, remove the ignition key and apply the parking brake.

The squeegee blades scrape the film of water and detergent from the floor and prepare the way for perfect drying. With time, and the constant wiping action, the edge of the blade in contact with the floor becomes rounded and cracked, diminishing its drying efficiency, so that ultimately a new blade is required. The state of wear should be checked frequently.

To ensure faultless drying, the squeegee must be adjusted as illustrated, in such a way that the edge of the rear blade deflects during operation by about 45° relative to the floor, at all points along its length.

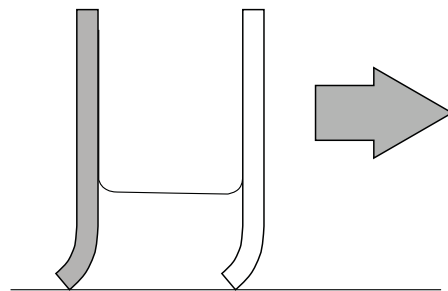

The angle of the blades can be adjusted by turning the knob positioned above the squeegee.

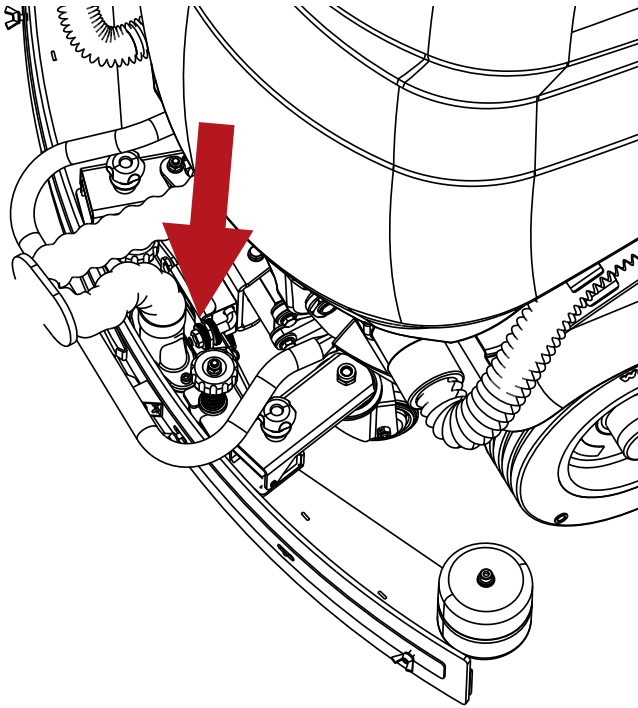

Similarly, the height of the squeegee can be adjusted by raising or lowering the two wheels positioned in front of / behind the squeegee, turning the relative knobs.

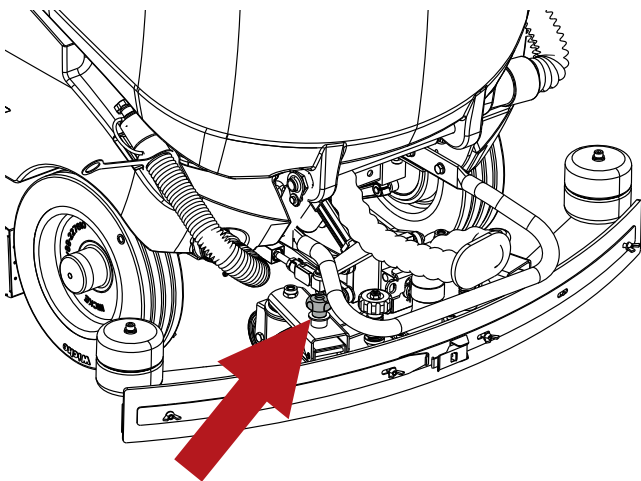

## Fitting the Brush/Pad Holder

**! ATTENTION:** before carrying out the operations described below, stop on a flat and level surface, switch off the machine, remove the ignition key and apply the parking brake.

**! ATTENTION:** Before installing the Pad Holder on the machine, make sure you have attached the PAD to the Pad Holder

Fitting the brushes (or Pad Holder):

- Raise the access flaps on both sides and position the brushes underneath the housing, making certain that they rest against the locating stops to align them with the coupling assembly.

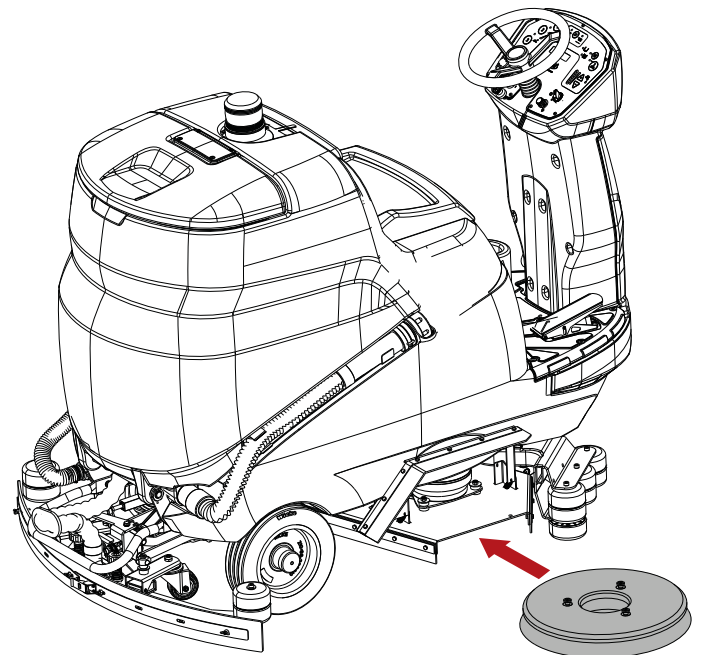
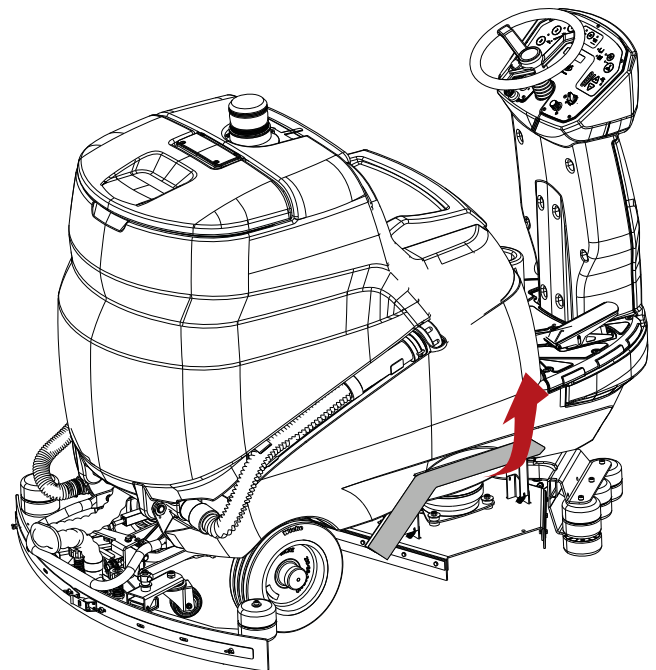

## Fitting the brushes (Cylindrical Brush Model)

**! ATTENTION:** before carrying out the operations described below, stop on a flat and level surface, switch off the machine, remove the ignition key and apply the parking brake.

### ! NOTICE

Where the terms **RIGHT** and **LEFT** appear, this is always referred to the forward movement of the machine

Assembly:

- Open the right side flap by releasing the spring.

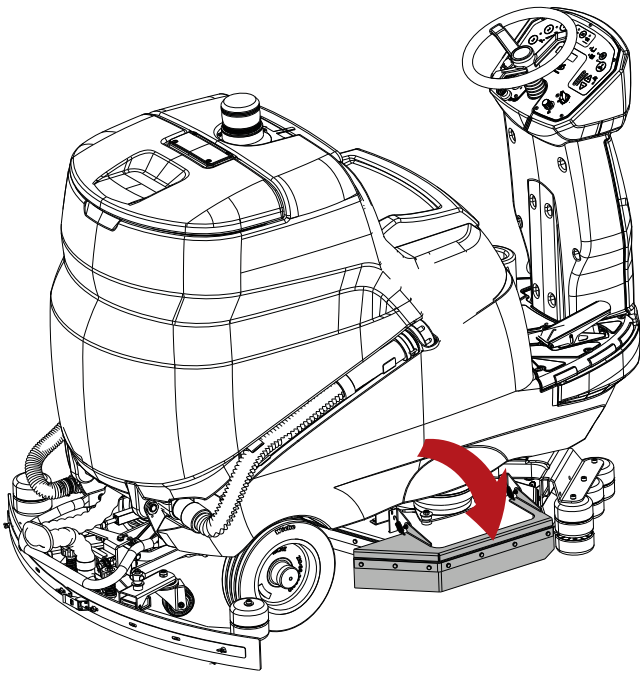

- Turn the ignition key to switch the machine on.

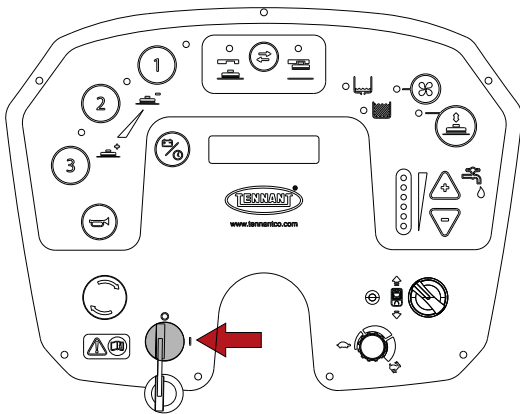

- Press the Attach/release brush button, the machine will first perform a release operation, which immediately enables the coupling operation; now the machine is ready for the coupling step, which can be accomplished by pressing the brush coupling and release button again.

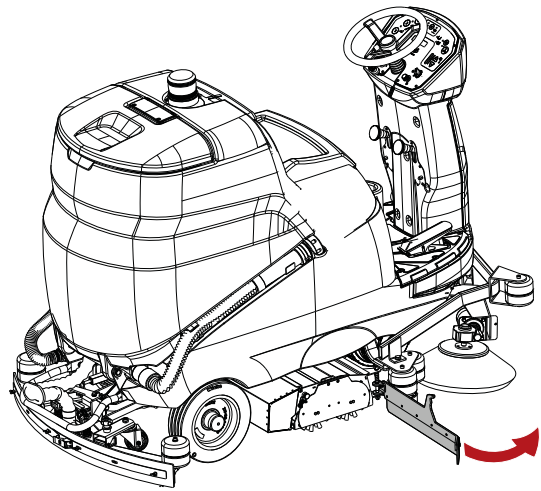

- Remove the cover from the brush compartment by pulling the release lever.

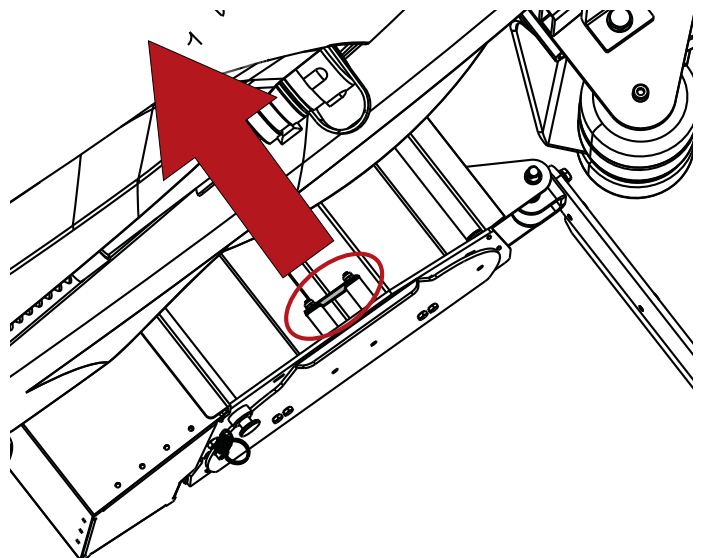

## Fitting the side brushes (Cylindrical Brush Model)

**! ATTENTION:** before carrying out the operations described below, stop on a flat and level surface, switch off the machine, remove the ignition key and apply the parking brake.

### ! NOTICE

Where the terms **RIGHT** and **LEFT** appear, this is always referred to the forward movement of the machine

#### Assembly:

- Undo the screw on the motor shaft.
- Check that the drive key is located in the keyway of the motor shaft.
- Position the brush complete with flange on the motor shaft.
- Retighten the clamp screw.

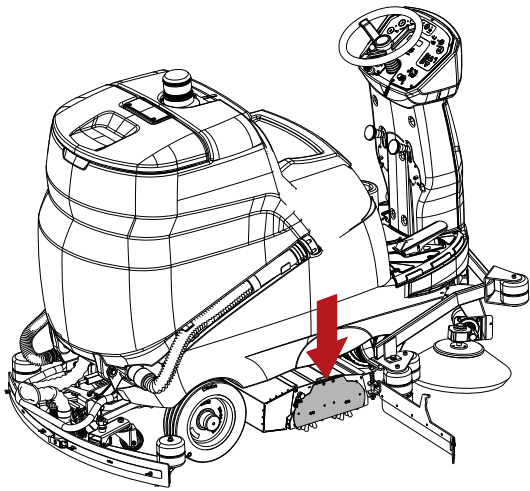

- Position the roller brushes in the two compartments, making certain that the guide pin on the opposite side is correctly located.

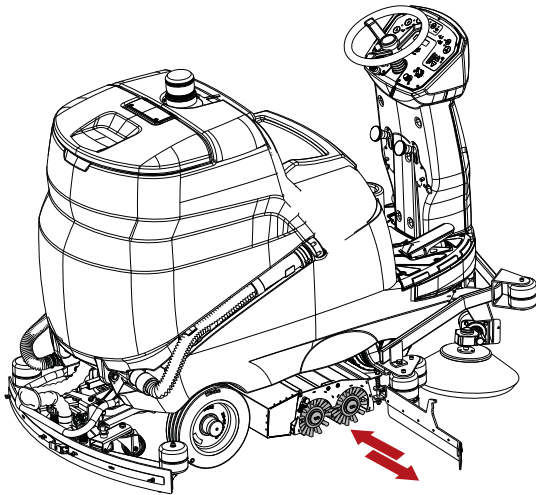

- Refit the cover and close the side flap.

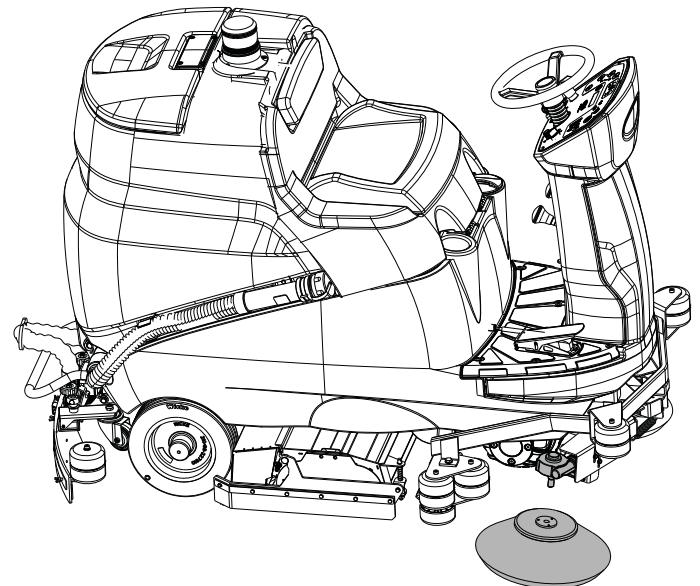
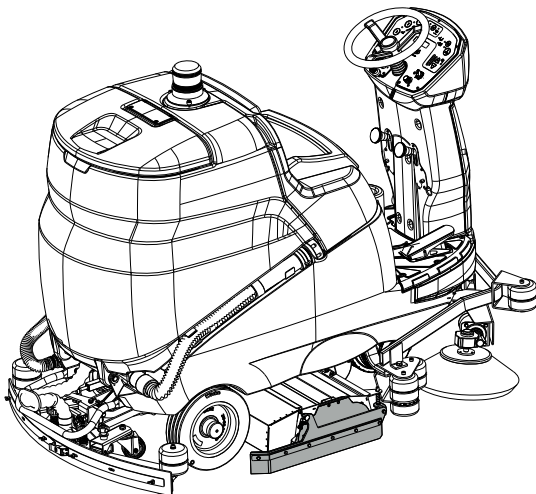

#### Disassembly:

- Repeat the steps described above in reverse order.

#### Disassembly:

- Repeat the steps described above in reverse order.

## Filling the detergent tank

**! ATTENTION:** before carrying out the operations described below, stop on a flat and level surface, switch off the machine, remove the ignition key and apply the parking brake.

**! DANGER:** flammable liquids can be the cause of explosion or fire. Do not introduce flammable liquids into the tank.

**! ATTENTION:** fill the tank with detergent at a temperature of between +4°C / 39.2°F and 55°C / 131°F.

**! ATTENTION:** the machine has been designed for use with detergents supplied or recommended by the Manufacturer. The use of other detergents or chemicals can affect the safety of the machine.

**! ATTENTION:** the selected detergent should be utilized rationally, in accordance with the directions given on the packaging of the product.

**! ATTENTION:** select a detergent from the range of recommended products that is most suitable for the washing operation in hand, and dilute with water following the instructions on the pack or in the catalogue.

Fill the tank through the opening provided.

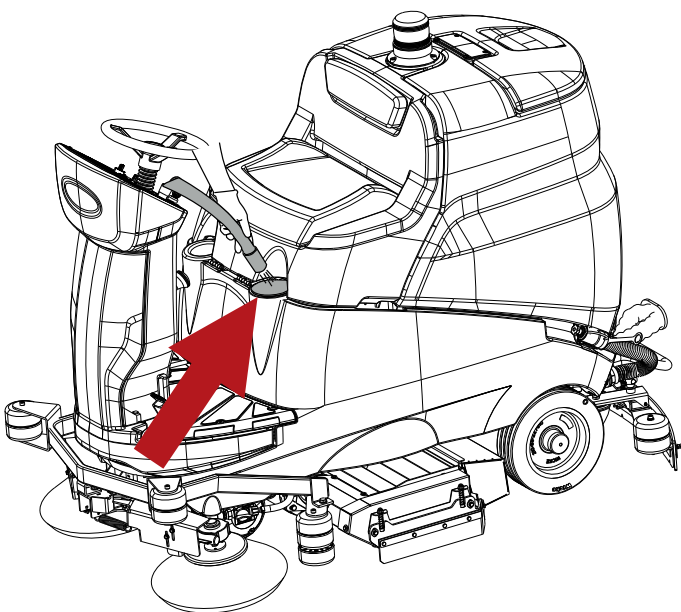

# PRACTICAL GUIDE FOR THE OPERATOR

## Clothing and equipment

Wear safety shoes with non-slip soles.

Wear protective goggles or visor and safety garments.

Depending on the surface being cleaned and on the environment, the protective measures necessary for atomized sprays include respiratory masks with class FFP2 or equivalent or higher protection.

## Before starting the machine

Clear away larger items of refuse before washing. Pick up any pieces of wire, tape, string and similar items that could become entangled around the brushes.

Before washing is commenced, sweep the area so as to avoid the appearance of streaks on the floor.

## Preparing the machine for work

Proceed as follows before starting work.

- Check that the batteries are fully charged, and if not, carry out the recharging procedure: when undertaking this operation, refer to the section “Charging the batteries”.
- Make certain that the dirty water tank is empty, and if not, empty it, referring to the section “Emptying the dirty water tank”.
- Make certain that the solution tank is full, and if not, proceed to fill it, referring to the section “Filling the water/detergent tank”.
- Make sure the solution flow tap is turned on.

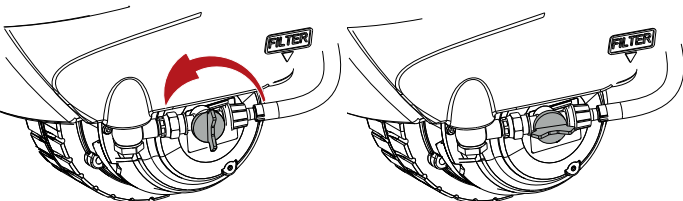

## Working

**! ATTENTION:** do not use the machine without first reading the operating and maintenance manual.

### ! NOTICE

Releasing the accelerator pedal, all of the functions are stopped automatically within 5 seconds (Power Off-On); in this standby condition, the indicator light corresponding to the selected program will blink. To reactivate the functions, simply move the machine forward, without deselecting the program (Power Off-On).

### ! NOTICE

Whenever the machine moves in reverse, the squeegee is raised automatically to prevent any possible damage.



**! DANGER:** Never use the machine to clean up flammable or explosive liquids (e.g. petrol, fuel oil, etc.), acids or solvents (e.g. paint thinners, acetone etc.) even if diluted.

- Sit on the seat.
- Turn the ignition key to switch the machine on.

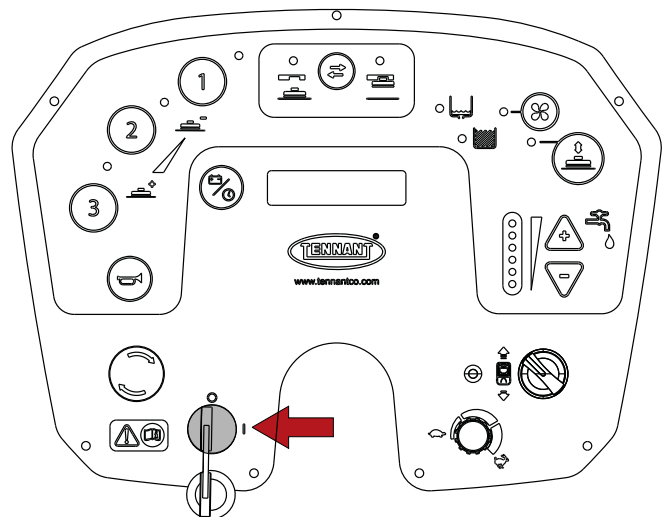

- Use the drive selector to select forward drive.

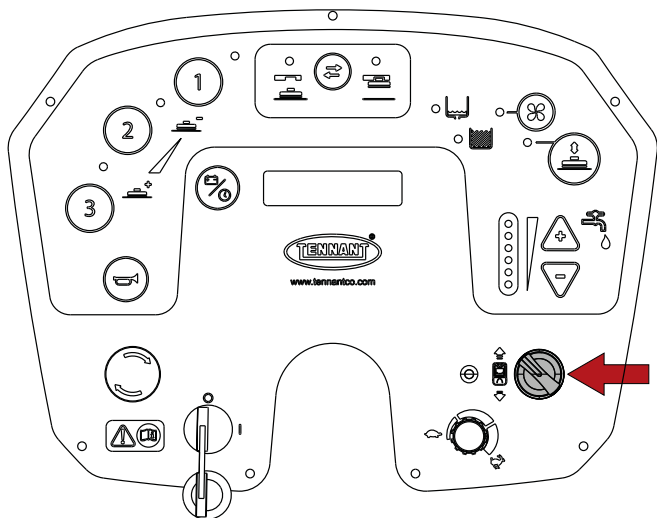

- From the three available programs, select the one most suitable for the work being performed; by pressing these buttons, all of the functions relating to the selected program will be activated (brush motor, suction motor):
  - 1, light intensity cleaning program for smooth floors, not excessively soiled.
  - 2, medium intensity cleaning program for smooth floors, noticeably soiled.
  - 3, high intensity cleaning program for rough floors (cement, etc.) soiled with stubborn dirt.

To change from one program to another, first deselect the existing program, then select the new program.

- **Cylindrical Brush Model:** lower the side brushes by pulling and lowering the levers. The brush motors will come into operation only when the brushes are completely lowered.

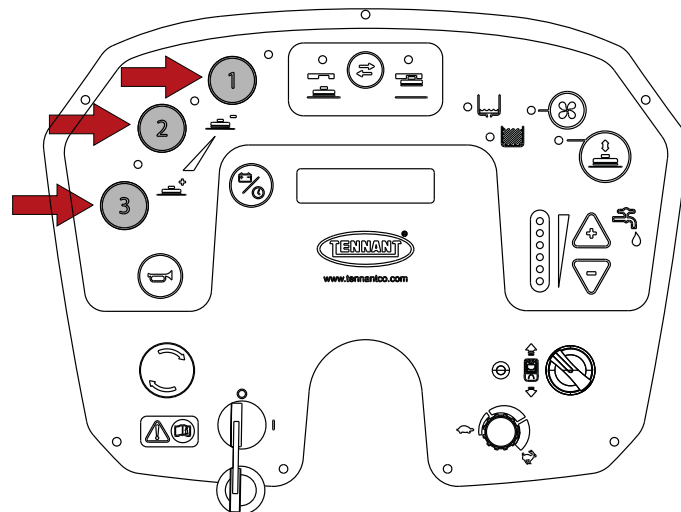

**! NOTICE**

A resettable fuse is fitted beneath each of the side brush operating levers. In the event that a side brush should stop working, press the button to reset the fuse.

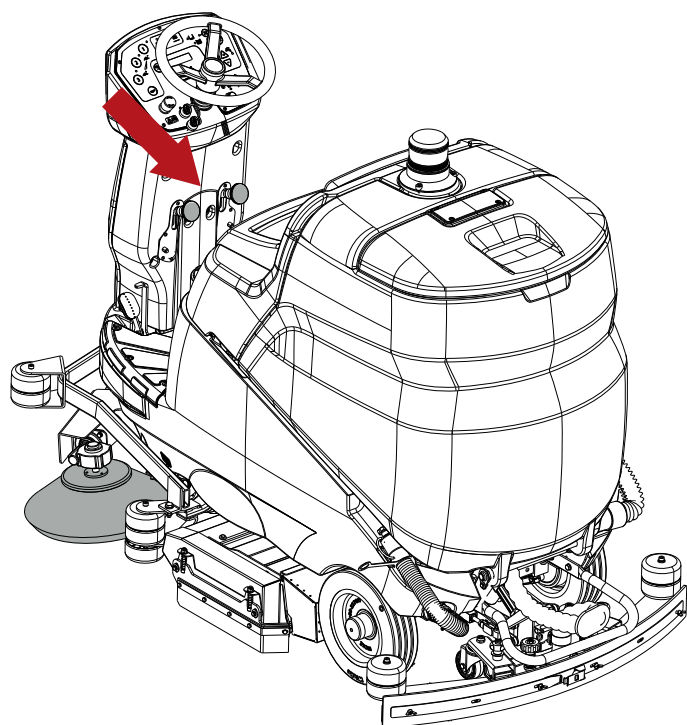

- Select the most suitable solution flow according to the type of washing operation, using the "+" and "-" buttons; Led indicators will light up to display the quantity.

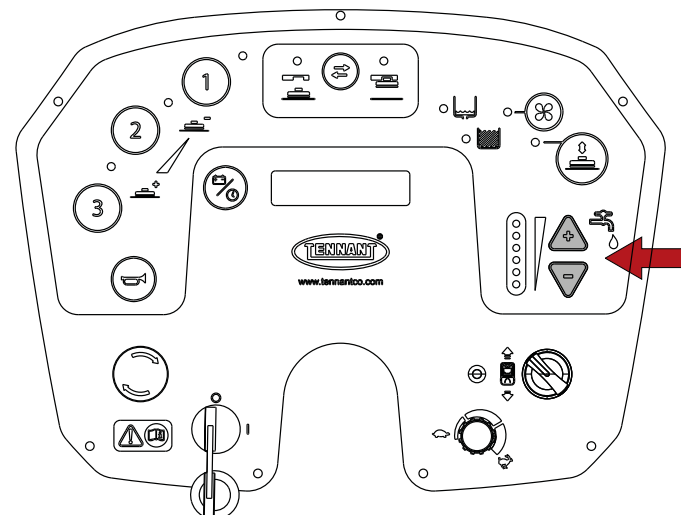

- Start cleaning, turning the steering wheel by hand and depressing the accelerator pedal. To apply the parking brake, depress the brake pedal fully.

**! NOTICE**

As a safety feature, the accelerator pedal must be pressed slowly at first to get machine to move.

- The maximum operating speed can be set by turning the speed potentiometer.

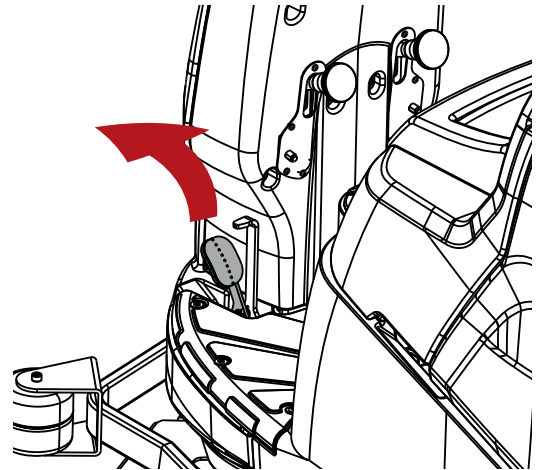
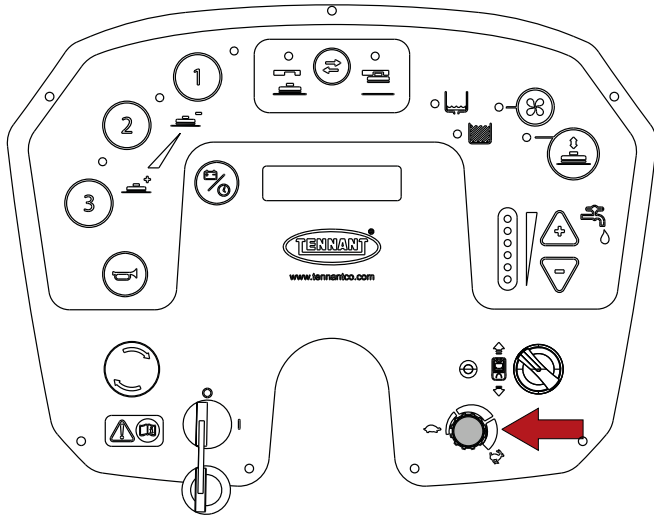

To release the parking brake, press the lever next to the pedal.

To stop the machine, release the accelerator pedal and depress the brake pedal; refer to the section "Service brake and parking brake".

**! NOTICE**

Cylindrical Brush Model: when finished cleaning, raise the side brushes.

**Service brake and parking brake**

To apply the service brake, depress the brake pedal and at the same time operate the parking brake release lever.

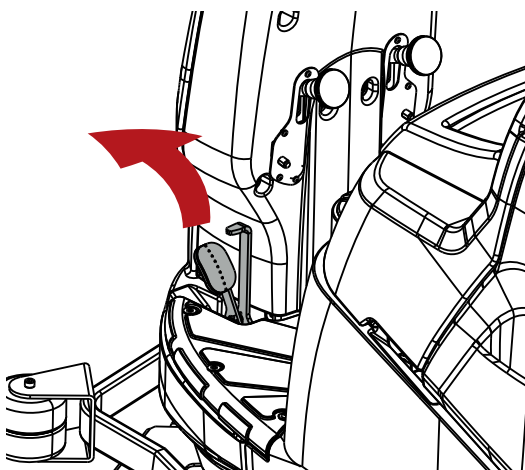
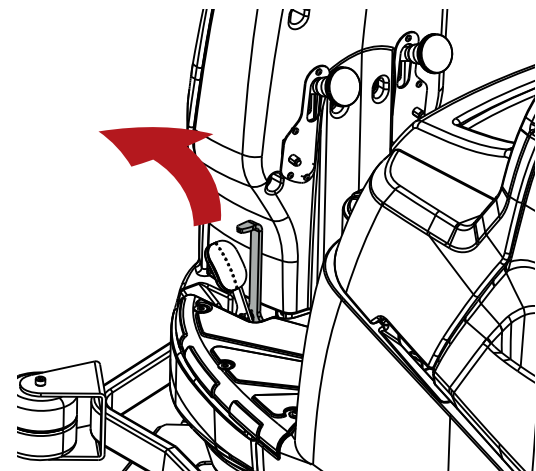

## Double Scrubbing

In cases where floors are soiled with particularly stubborn dirt, scrubbing and drying operations can be performed in two separate stages.

Prewash with brushes or pads:

- Turn the ignition key to switch the machine on.

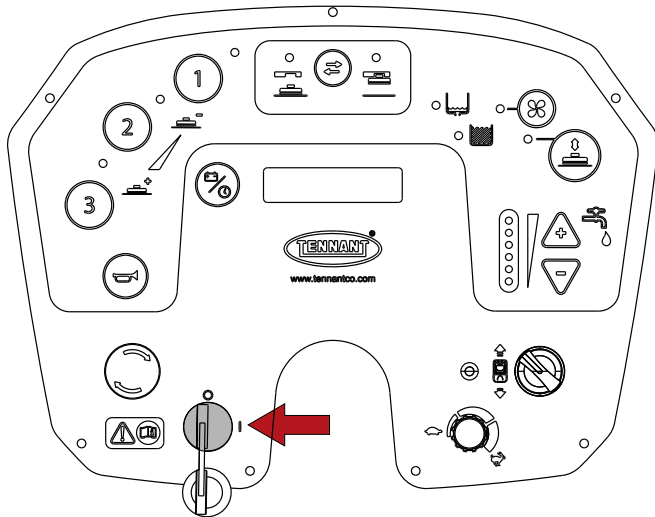

- Press the brush button.

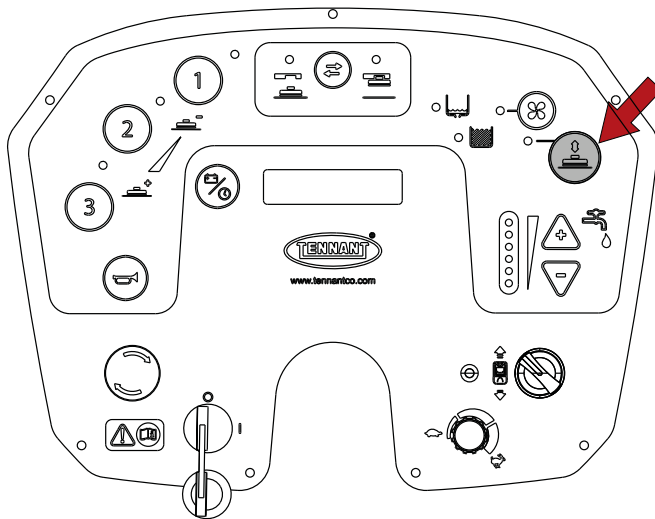

- Set the detergent solution flow.

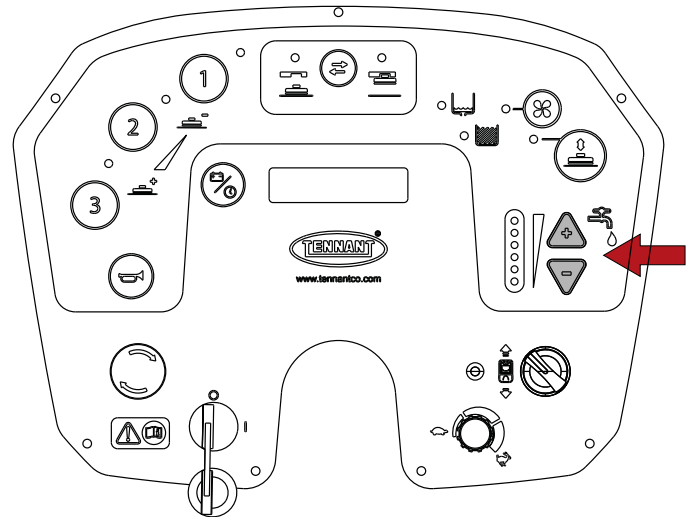

- When scrubbing particularly dirty areas, give the detergent sufficient time to perform its chemical action of detaching and suspending the dirt in the film of water, and allow the brushes time to exert an effective mechanical action.

Drying:

- Press the suction motor button: the suction fan switches on and the squeegee is lowered.

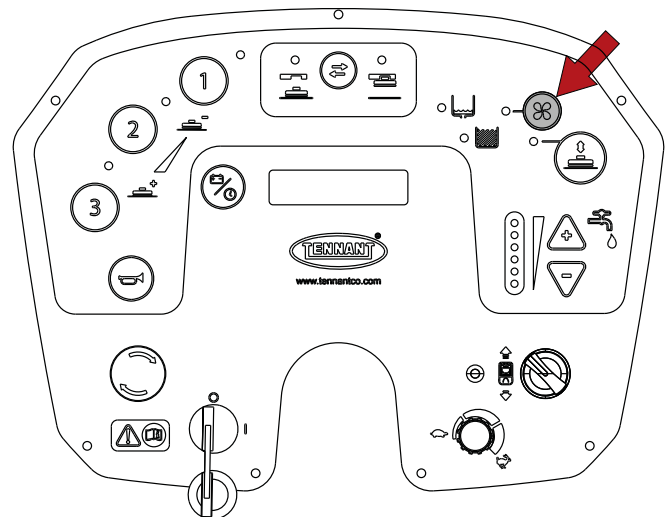

- Pass the machine over the area washed previously: the effect will be to produce a deep cleansing action, with the result that subsequent routine maintenance operations will take much less time.

## Picking up water (without scrubbing)

The machine can be used to mop up spills of water or NON-flammable liquids, without any cleaning action.

Press the suction motor button: the squeegee is lowered and the suction fan comes into operation.

Proceed to pick up the liquids.

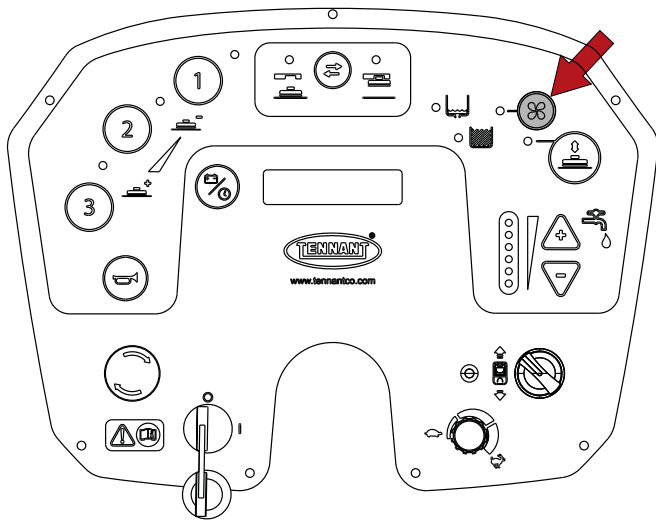

**! ATTENTION:** do not attempt to clean surfaces on slopes or gradients steeper than indicated on the machine data plate.

**! ATTENTION:** Do not operate the machine on slopes or gradients steeper than indicated on the data plate.

**! ATTENTION:** When using the machine on gentle gradients, do not move transversely across the slope, but keep the machine on a line parallel to the direction of the incline, manoeuvring carefully and without making U-turns.

## Emergency stop button

In the event of emergency, this button isolates the machine from its power source.

To cut off the power supply, press the button.

To restart the machine, rotate the button and cycle the key.

## During operation of the machine

- Keep the cleaning passes as straight as possible.
- Overlap successive cleaning passes by a few centimetres.
- Adjust the ground speed of the machine, the contact pressure of the brush and the flow of detergent to suit the type of cleaning. Use the minimum available settings, as far as practically possible, for the brush pressure and detergent solution flow.
- Check the battery charge indicator to ensure there will be sufficient power for completion of the cleaning operation.
- Check the detergent solution level indicator to ensure that the relative tank is not empty.
- Check the dirty water level indicator to ensure that the relative tank is not full.
- Keep the machine moving forward to prevent damage to floor finishes.

**! ATTENTION:** the scrubhead and squeegee will automatically raise to the transport position if key is turned off. Stay clear of moving parts to avoid potential pinch hazard.

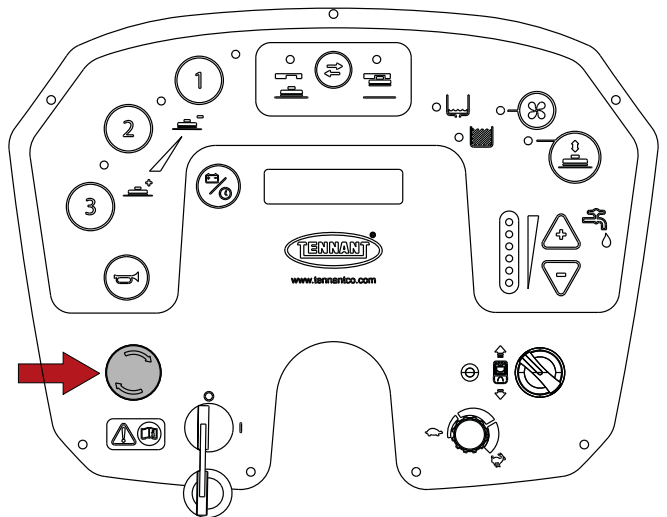

## Detergent solution tank empty indicator

When the solution tank is empty, the indicator lights up and all cleaning functions are inhibited. The detergent solution tank must now be filled: when carrying out this operation, refer to the section “Filling the detergent solution tank”.

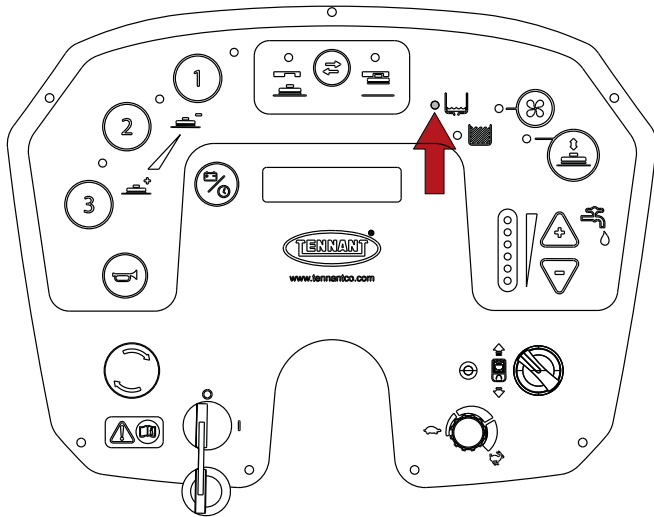

## Battery charge indicator

The display indicates the battery voltage: when this drops below a specific level the cleaning functions will be disabled, whereas traction remains enabled; proceed with the recharge, following the instruction given in the section “Recharging the batteries”.

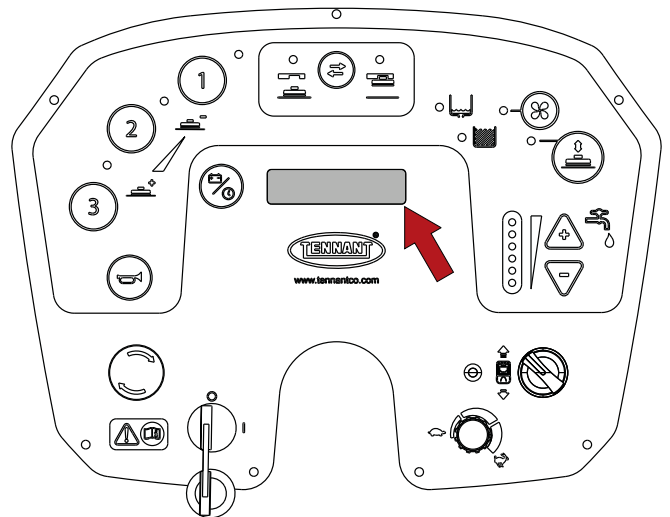

## Dirty water tank full indicator

When the dirty water tank is full, the indicator lights up and all cleaning functions are inhibited. The dirty water tank must now be emptied: when carrying out this operation, refer to the section “Emptying the dirty water tank”.

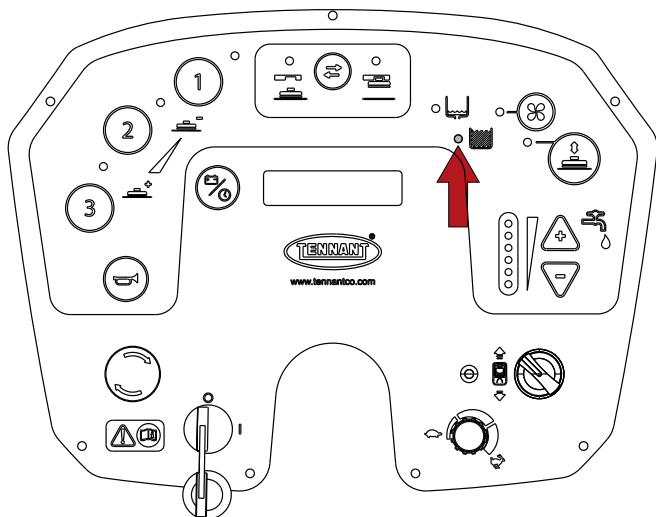

## Emptying the dirty water tank

**! ATTENTION:** before carrying out the operations described below, stop on a flat and level surface, switch off the machine, remove the ignition key and apply the parking brake.

When cleaning operations have been completed, empty the dirty water tank.

If the tank is full, the indicator lights up and the cleaning functions of the machine will be inhibited; after a few seconds, the suction motor also shuts down. At this point the machine must be brought to a halt and the dirty water tank emptied, following the instructions indicated below:

- Take the machine to the designated service area.
- Unhook the hose from the clip.
- Empty the tank by way of the drain hose: keep the hose raised initially and remove the plug, then lower the hose gently and position it over the drain outlet.
- Rinse the tank with clean water.
- Rinse the float of the dirty water tank, referring to the directions given in the section “Cleaning the dirty water tank sensor”.
- Refit the plug to the drain hose and reattach the hose to the clip.

## Emptying the cylindrical brush debris bin

**! ATTENTION:** before carrying out the operations described below, stop on a flat and level surface, switch off the machine, remove the ignition key and apply the parking brake.

To empty the cylindrical brush debris bin, rotate the bottom of the bin clockwise then pull bin directly outward. Empty the debris and wash the bin.

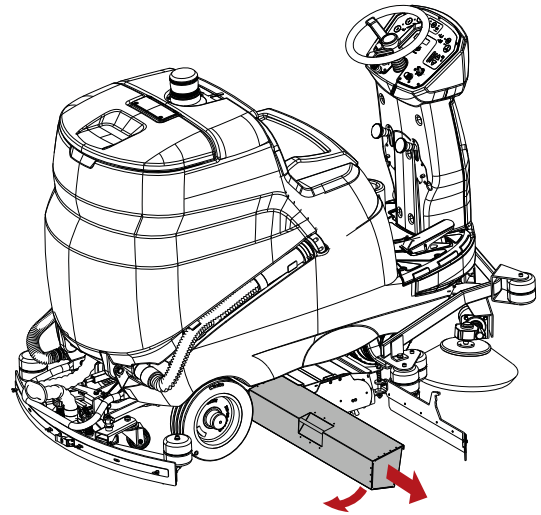
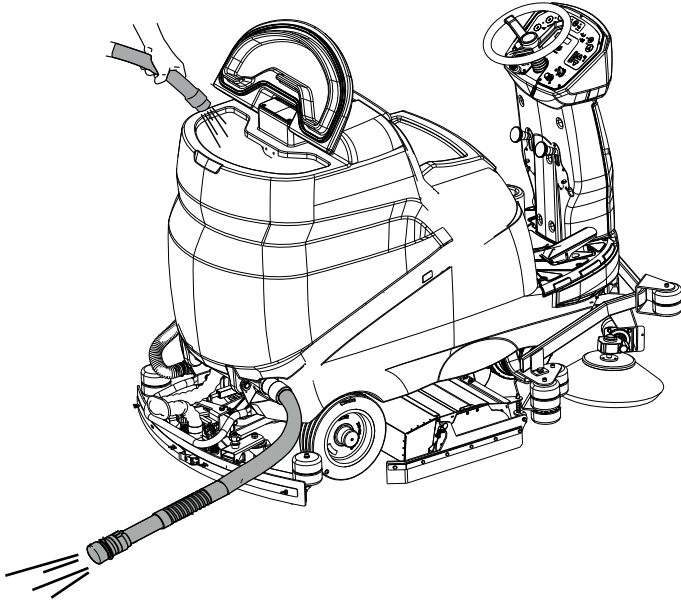

## Emptying the solution tank

**! ATTENTION:** before carrying out the operations described below, stop on a flat and level surface, switch off the machine, remove the ignition key and apply the parking brake.

The detergent solution tank can be emptied by proceeding as follows:

- Take the machine to the designated service area.
- Unhook the hose from the clip.
- Empty the tank by way of the drain hose: keep the hose raised initially and remove the plug, then lower the hose gently and position it over the drain outlet.

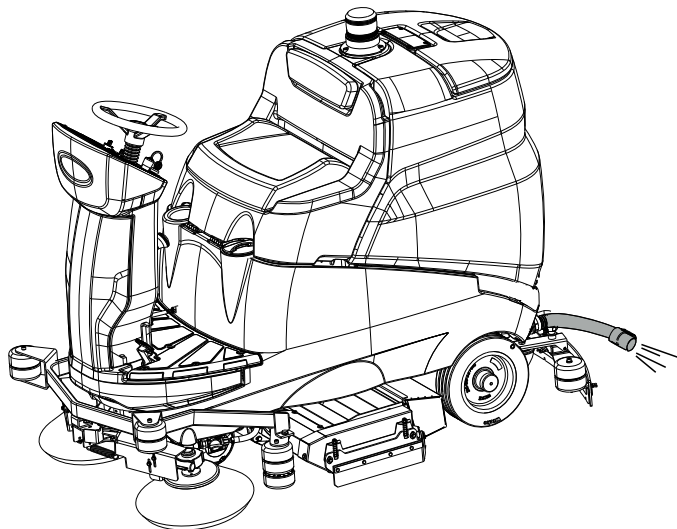

## Removing the the Brush/Pad Holder

**! ATTENTION:** before carrying out the operations described below, stop on a flat and level surface and apply the parking brake.

- Turn the ignition key to switch the machine on.
- Press the Attach/Release brush button, and the machine will perform the release operation;

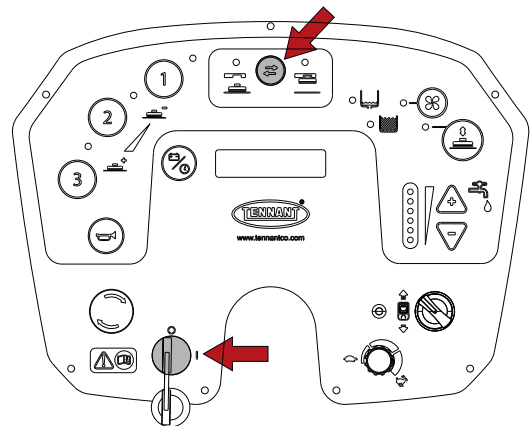

- lift the side flaps on both sides and remove the brushes from under the head.

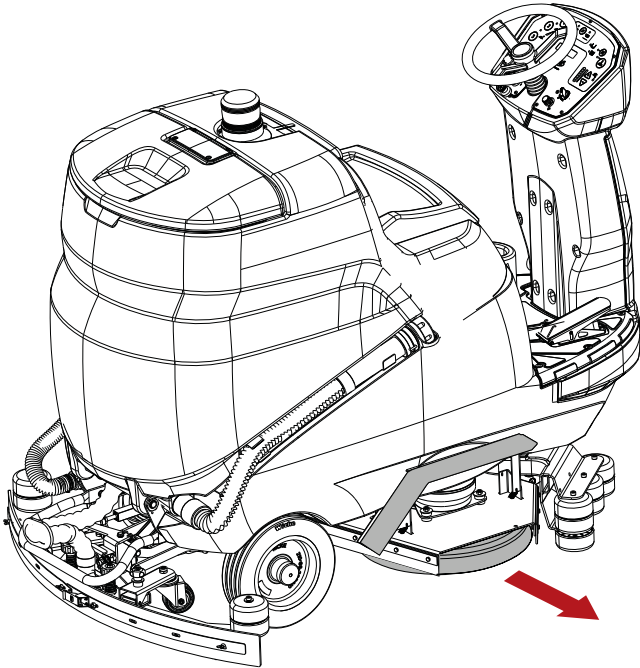

### Moving the machine when not in operation

To move the machine, proceed as follows:

- Turn the ignition key to switch the machine on.
- Press the accelerator pedal.
- The top speed of the machine is adjusted by turning the potentiometer.
- To stop the machine, release the accelerator pedal and depress the brake pedal; refer to the section **“Service brake and parking brake “**.
- Turn the ignition key to switch off the machine.
- Apply the parking brake: see section **“Service brake and parking brake “**.

# **MAINTENANCE INSTRUCTIONS**

**! DANGER:** no maintenance work of any description must be carried without first having isolated the machine from its power source. Maintenance operations on the electrical circuit — and in any event, all other operations not explicitly described in this operating manual — must be performed by a TENNANT approved service technician, in compliance with current safety regulations and as indicated in the maintenance manual.

**! DANGER:** before lifting/turning the tank to access the housing, it must be emptied of its contents.

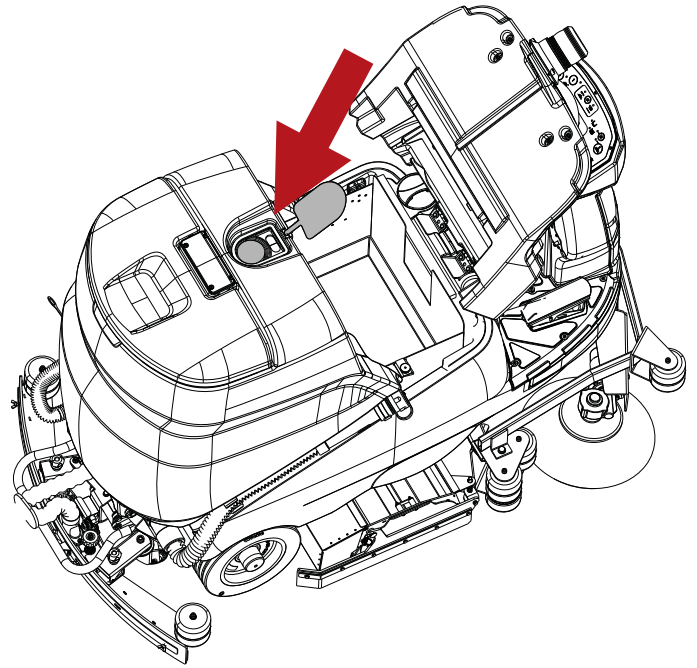

## **Maintenance - General rules**

Performing regular maintenance according to the Manufacturer's instructions will improve performance and extend the working life of the machine.

When cleaning the machine, always observe the following precautions:

Avoid using pressure washers. Water could penetrate the electrical compartment or motors leading to damage or short circuits;

Avoid using steam, as the heat could cause the deformation of plastic parts;

Do not use solvents or hydrocarbon based products. These can damage the cowling and rubber components.

## **Cleaning the suction motor air filter**

**! ATTENTION:** before carrying out the operations described below, stop on a flat and level surface, switch off the machine, remove the ignition key and apply the parking brake.

Tilt the seat forward, raise the filter cover and remove the filter from its housing; wash the filter under running water or with the detergent used in the machine, then dry thoroughly and reposition in the housing.

## **Cleaning the dirty water tank sensor**

**! ATTENTION:** before carrying out the operations described below, stop on a flat and level surface, switch off the machine, remove the ignition key and apply the parking brake.

Raise the lid of the dirty water tank, and clean the sensor as appropriate.

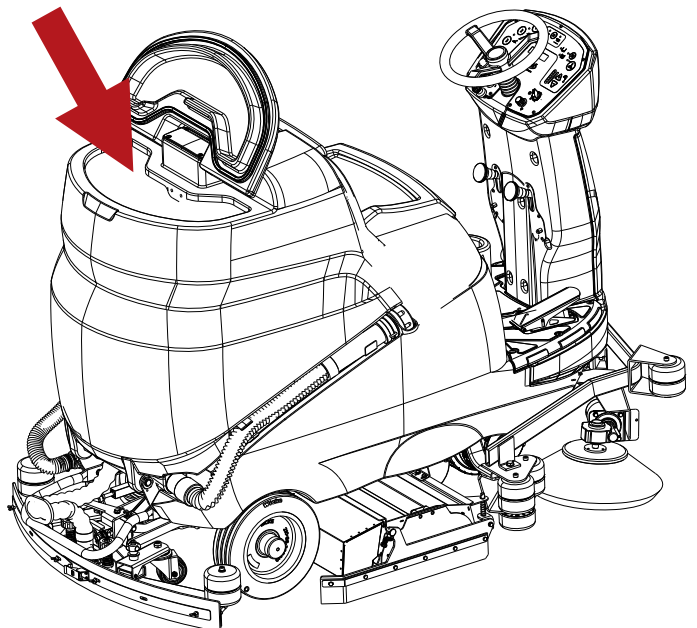

## Cleaning the solution tank filter

**! ATTENTION:** before carrying out the operations described below, stop on a flat and level surface, switch off the machine, remove the ignition key and apply the parking brake.

To clean the filter, proceed as follows:

- Shut off the tap upstream of the filter.
- Unscrew the filter cap, remove the filter, then wash under running water or using the same detergent dispensed by the machine.
- Replace the filter in its housing, making sure it is correctly positioned and screw the lid back on.

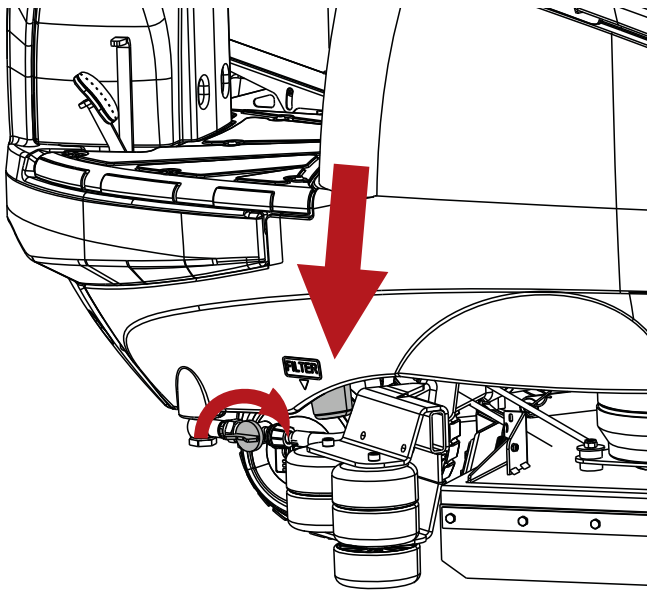
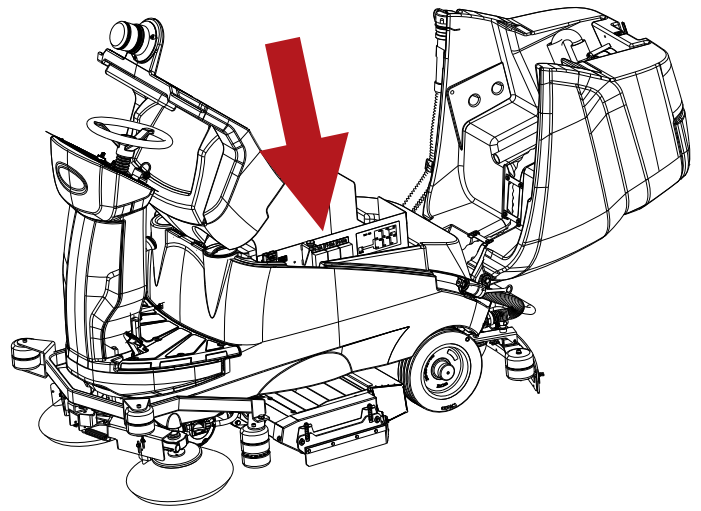

## Fuses:

**! ATTENTION:** before carrying out the operations described below, stop on a flat and level surface, switch off the machine, remove the ignition key and apply the parking brake.

**! ATTENTION:** never install a fuse with a current rating higher than that specified.

The replacement of fuses must be entrusted only to a TENNANT service centre or to a TENNANT-approved service technician.

Tilt the tank to the rear, disconnect the battery wiring connector from the electrical system or unplug the mains power cable, and remove the cover to access the fuses.

## ! NOTICE

A resettable fuse is fitted beneath each of the side brush operating levers. In the event that a side brush should stop working, press the button to reset the fuse.

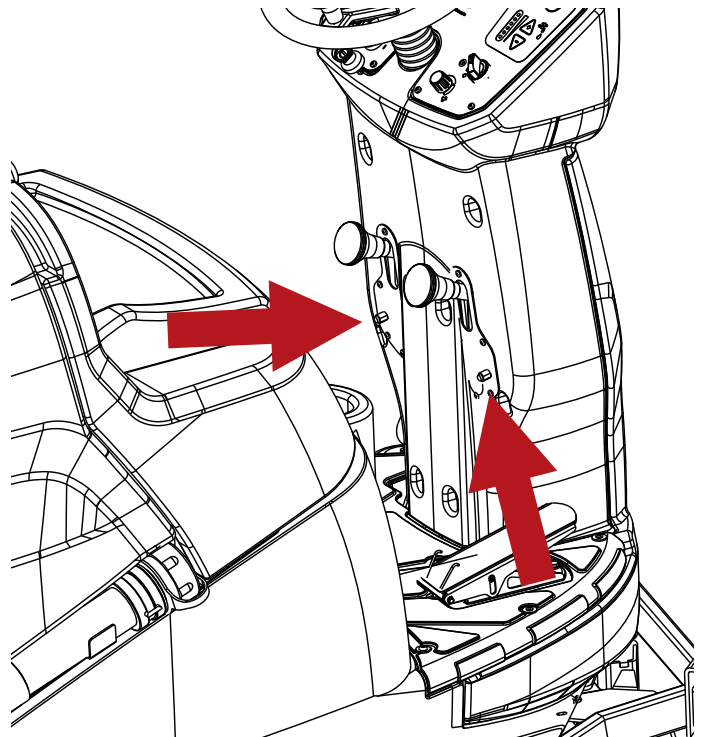

## Battery maintenance



**! DANGER:** do not check the batteries by sparking. Lead-acid (WET) batteries give off flammable vapours: extinguish any naked flames or embers before checking or topping up the batteries.

**! DANGER:** during any type of maintenance on the batteries, the skilled technician must wear the Personal Protective Equipment (gloves, eyewear, overalls, etc.) needed to limit the risk of accidents. Keep away from naked flames, do not short circuit the battery poles, do not generate sparks and do not smoke.

**! DANGER:** in the event of battery fluid leakage, do not touch the fluid and observe the following precautions:  
**Contact with the skin can cause irritation; wash with soap and water.**  
**Inhalation of vapours can cause irritation to the airways; stay out in the open air and consult a doctor.**  
**Contact with the eyes can cause irritation; wash the eyes immediately, flooding with water for at least 15 minutes, and consult a doctor.**

Useful battery life is dependent on proper maintenance. To obtain best possible efficiency from batteries, observe the following rules:

- Do not leave batteries partially discharged for long periods of time.
- Allow batteries to charge completely before resuming use of the machine.
- Keep batteries clean, with the connections always well tightened.
- Check the level of the electrolyte every week (WET batteries).

### Checking the electrolyte level of WET batteries

WET batteries must be inspected periodically to check the level of the electrolyte. Use only distilled water to top up the level so that the plates are covered. Do not overfill (maximum 5 mm / 0.19 in above the plates), as the electrolyte could expand and overflow when the battery is charged.

### Recharging the batteries

**! DANGER:** do not check the batteries by sparking. Lead-acid (WET) batteries give off flammable vapours: extinguish any naked flames or embers before checking or topping up the batteries.

**! DANGER:** carry out the operations described below in a ventilated area.

**! DANGER:** when charging the batteries, highly explosive hydrogen gas is produced. Keep the operator seat tilted toward the steering wheel throughout the battery charging cycle and carry out this procedure only in well-ventilated areas, away from naked flames.

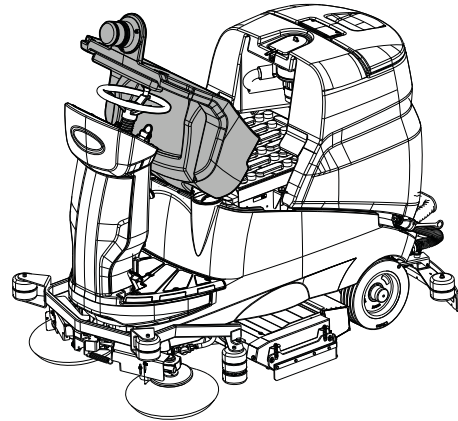

**! ATTENTION:** before carrying out the operations described below, stop on a flat and level surface, switch off the machine, remove the ignition key and apply the parking brake.

**! ATTENTION:** before recharging, make certain that the battery charger is set up correctly for the type of battery installed.

**! ATTENTION:** run the recharge cycle exactly as specified in the battery charger manual, and at the end of the cycle, detach the connectors.

- Disconnect the battery pack connector from the electrical system of the machine.
- Connect the battery pack connector to the connector of the battery charger.
- Plug the battery charger into the mains power socket.
- Start the recharge cycle.

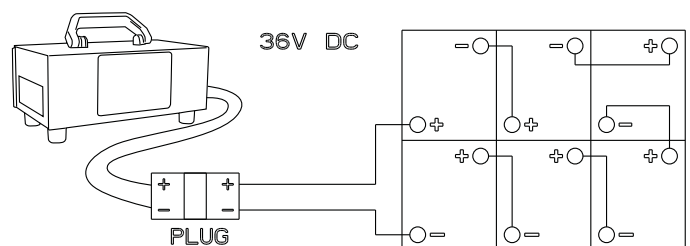

## Battery: removal



**! DANGER:** in the event of battery fluid leakage, do not touch the fluid and observe the following precautions:

Contact with the skin can cause irritation; wash with soap and water.

Inhalation of vapours can cause irritation to the airways; stay out in the open air and consult a doctor.

Contact with the eyes can cause irritation; wash the eyes immediately, flooding with water for at least 15 minutes, and consult a doctor.



**! DANGER:** When removing the batteries, the skilled technician must wear the Personal Protective Equipment (gloves, eyewear, overalls, etc.) needed to limit the risk of accidents; remove the ignition key from the control panel before proceeding with the removal operation, keep away from naked flames, do not short circuit the battery poles, do not cause sparks and do not smoke.

**! ATTENTION:** the operation of removing the batteries must be carried out by a skilled technician.

**! ATTENTION:** before carrying out the operations described below, stop on a flat and level surface, switch off the machine, remove the ignition key and apply the parking brake.

- Disconnect the battery cables and bridge terminals from the battery poles.
- If necessary, remove the devices fixing the battery to the base of the machine.
- Lift the batteries from the compartment using suitable handling equipment.

## Replacement of Brushes and Pads

The machine can be equipped with disc brushes, roller brushes and pads. Check the brushes and the pads every day to make certain there are no wires, threads or strings entangled around the brush or the drive board. Check for wear on the brushes and the pads.

Replace the brushes when the bristles are worn down to the point of exposing the red indicator.

Replace the pads when they no longer clean efficiently.

Wash the brushes and pads with soap and water following use, and hang them up to dry.

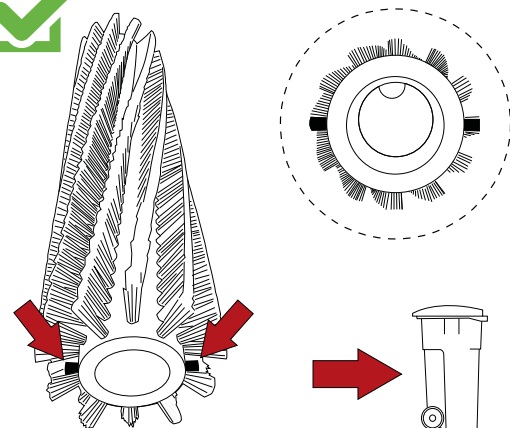
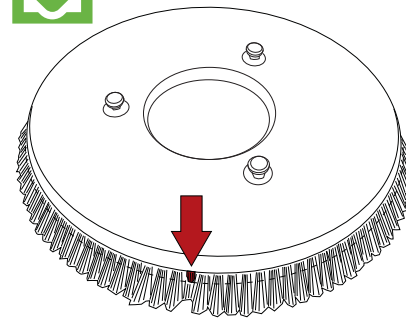

## Replacing the squeegee blades

**! ATTENTION:** before carrying out the operations described below, stop on a flat and level surface, switch off the machine, remove the ignition key and apply the parking brake.

The squeegee blades collect the film of water and detergent from the floor and prepare the way for perfect drying. With time, and the constant wiping action, the edge of the blade in contact with the floor becomes rounded and cracked, diminishing its drying efficiency, so that ultimately a new blade is required.

- Remove the suction hose from the squeegee.
- Remove the squeegee from its mount by unscrewing the two knobs completely.
- Release the locking catch and unscrew the nuts for the rear blade; for the front blade, unscrew the nuts.
- Remove the blade retainers.
- Remove the blade.
- Refit the same rear blade, switching it around so that all four edges in turn are placed in contact with the floor, until all are worn out, proceeding likewise for the front blade, in this case until the two edges are worn out; alternatively, replace with a new blade, fitting it to the screws on the body of the squeegee.
- Refit the blade retainers.
- Refit the locking catch and retighten the nuts for the rear blade, and for the front blade, retighten the nuts.
- Replace the squeegee on its mount.

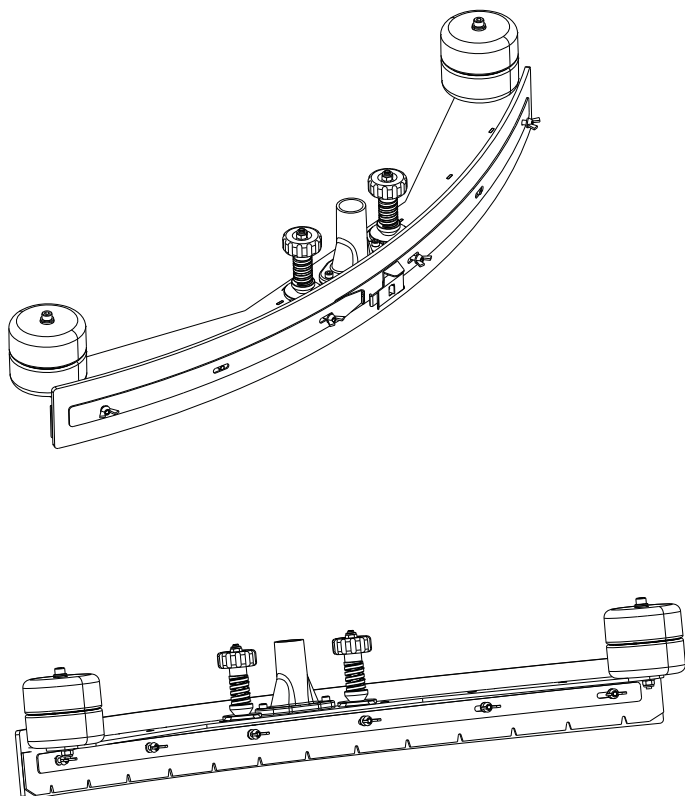

## Cylindrical Brush Model side brushes wear adjustment

**! ATTENTION:** before carrying out the operations described below, stop on a flat and level surface, switch off the machine, remove the ignition key and apply the parking brake.

If the side brushes (when lowered) do not touch the floor due to excessive wear, they can be adjusted as follows:

- Move the side brush to the working position.
- Loosen the adjustment screws on the brush motor support.
- Position the brush by hand, as required.
- Tighten the adjustment screws.

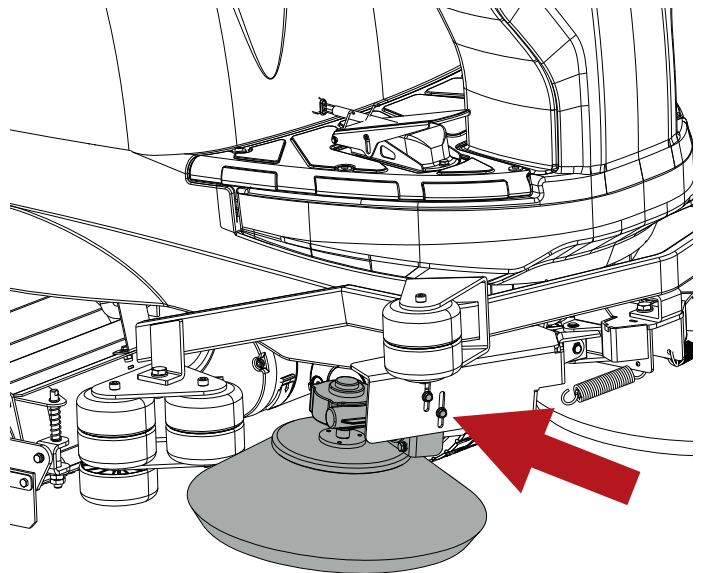

## Machine Jacking

**! ATTENTION:** before carrying out the operations described below, stop on a flat and level surface, switch off the machine, remove the ignition key and apply the parking brake.



**! DANGER:** when lifting the machine, use suitable equipment with a load capacity sufficient to carry its weight.



**! DANGER:** the machine must be lifted only from the points indicated below.



**! DANGER:** empty the dirty water and detergent solution tanks before lifting the machine.

**! DANGER:** remove the batteries before lifting the machine.

**! INFORMATION**  
Front and rear lifting points are provided on both sides of the machine.

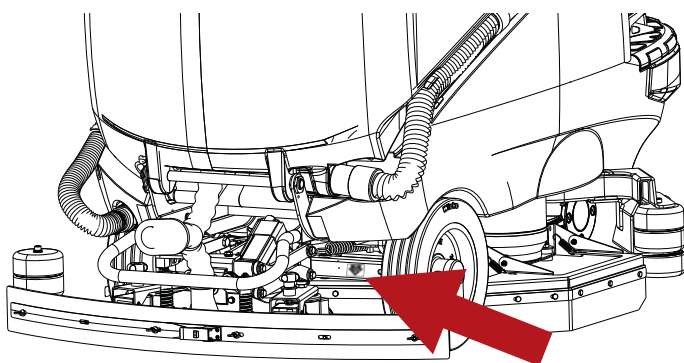
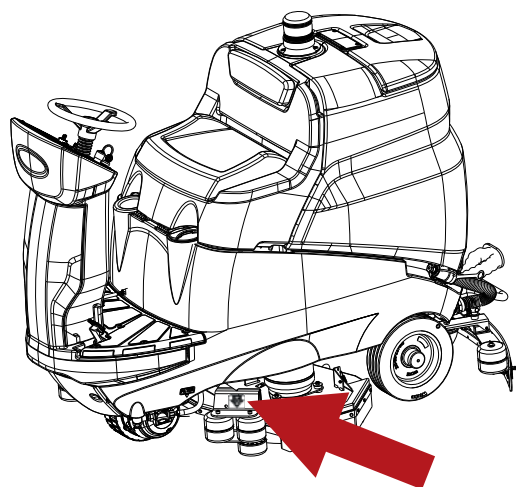

|   |  |   |   |
|---|--|---|---|
| CLEAN THE DIRTY WATER TANK FLOAT  |  | X |   |
| CLEAN THE SUCTION MOTOR AIR FILTER  |  | X |   |
| CLEAN THE SOLUTION TANK FILTER  |  | X |   |
| CLEAN THE SQUEEGEE  |  | X |   |
| CLEAN THE DIRTY WATER TANK AND THE SOLUTION TANK                            |  | X |   |
| CHECK THE BATTERY ELECTROLYTE LEVEL   |  | X |   |
| HAVE THE ELECTRICAL SYSTEM CHECKED BY A TENNANT-APPROVED SERVICE TECHNICIAN |  |   | X |

## PERIODS OF INACTIVITY

If the machine is not used for some time, for example, on display in a showroom or stored in the warehouse for a period of more than one month, the following operations are required:

- Recharge the batteries completely. During long periods of inactivity, remember to recharge the batteries periodically (at least once every two months) so that they are kept at the maximum charge level.
- Disconnect the batteries from the machine.
- Unplug the battery charger (if present) from the mains power supply.
- The squeegee and brushes (or abrasive disks) must be removed from the machine, washed and stored in a dry place (preferably in a bag or wrapped in plastic sheet) away from dust.
- Make certain that the tanks are completely empty and perfectly clean.

## Periodic checks

| CHECK  | DAILY OPERATIONS | WEEKLY OPERATIONS | SIX MONTHLY OPERATIONS |
|--|------------------|-------------------|------------------------|
| EMPTY AND WASH THE DIRTY WATER TANK                        | X                |                   |                        |
| CLEAN THE SQUEEGEE BLADES AND CHECK THEM FOR WEAR          | X                |                   |                        |
| CHECK THAT THE SUCTION HOLE IN THE SQUEEGEE IS NOT BLOCKED | X                |                   |                        |
| RECHARGE THE BATTERIES                                     | X                |                   |                        |

**! ATTENTION:** remember to check the batteries — if they are not recharged periodically as described above, they could become damaged beyond repair. The manufacturer is not liable for any malfunctions resulting from neglect, improper and/or incorrect use.

**! ATTENTION:** when the batteries discharge to the minimum level, make certain they are not left in this condition for any length of time, as this can reduce their working life. Check the battery charge level at least once a week

# TROUBLESHOOTING

| PROBLEMS   | CAUSES   | SOLUTIONS   |
|--|--|---|
| The machine does not work                            | The batteries are disconnected   | Connect the batteries to the machine  |
|  | The batteries are flat   | Recharge the batteries  |
|  | Fuse tripped   | Reset the fuse  |
|  | Ignition key not engaged   | Turn the key  |
|  | Emergency button pressed   | Release the emergency button  |
| Head brushes not turning                             | The dirty water tank is full   | Empty the dirty water tank  |
|  | Fuse tripped   | Reset the fuse  |
|  | The batteries are flat   | Recharge the batteries  |
|  | Damaged motor  | Replace   |
| Head side brushes not turning                        | Fuse tripped   | Reset the fuse  |
|  | Damaged motor  | Replace   |
| The machine does not clean uniformly                 | The brush or disks are worn  | Replace   |
| No solution comes out of the detergent tank          | Damaged solenoid valve   | Replace   |
|  | Dirty solenoid valve   | Check   |
|  | Detergent solution tank empty  | Top up  |
|  | The hose delivering detergent to the brush is blocked                              | Unblock   |
|  | The tap upstream of the filter is closed   | Open the tap  |
|  | Fuse tripped   | Reset the fuse  |
| Detergent flow does not stop                         | Damaged solenoid valve   | Replace   |
|  | Dirty solenoid valve   | Clean   |
| The suction motor does not start                     | The dirty water tank is full   | Empty the dirty water tank  |
|  | Fuse tripped   | Reset the fuse  |
|  | The batteries are flat   | Recharge the batteries  |
|  | Damaged motor  | Replace   |
| The squeegee does not clean or has poor suction      | The edge of the rubber blades in contact with the floor is worn                    | Replace the blades  |
|  | Squeegee blocked or damaged  | Check   |
|  | The dirty water tank sensor has been activated or is blocked by dirt, or is faulty | Empty the dirty water tank, check the sensor.   |
|  | Blockage in the suction hose   | Check   |
|  | The suction hose is not connected to the squeegee or is damaged                    | Check   |
| The machine does not move                            | The batteries are flat   | Recharge the batteries  |
|  | Damaged motor  | Replace   |
|  | Accelerator pedal pressed too quickly  | Press accelerator pedal slowly when starting out  |
| The batteries do not provide the normal working time | The battery poles and charging terminals are dirty and oxidised                    | Clean and grease the poles and terminals, charge the batteries                                      |
|  | The electrolyte has evaporated and is not covering the plates completely           | Top up all elements with distilled water so that all plates are covered, then recharge the battery. |
|  | The battery charger does not work or is not suitable                               | Check   |

## ALARMS/WARNINGS DISPLAYED

| ERROR CODE        | CAUSE   | SOLUTION  |
|-------------------|---|---|
| BRUSH TEMPER.     | Machine being overworked.                                       | Wait 30 minutes for the temperature to come down.     |
|                   | The work program selected is too heavy for the type of surface. | Drop from 3 to 2 or 1.                                |
|                   | Electronics damaged   | Replace the power pcb.                                |
| BATTERY RESERVE   | Battery voltage low   | Charge the battery.                                   |
| BATTERY FLAT      | Battery voltage low   | Charge the battery.                                   |
| EXHAUSTED BATTERY | Battery voltage low   | Check the battery acid level and top up if necessary. |
| PARKING BRAKE     | Parking brake engaged.  | Release the parking brake.                            |
|                   | Brake pedal microswitch not mounted correctly.                  | Adjust the position of the microswitch.               |
|                   | Brake pedal microswitch not functioning correctly.              | Replace the microswitch.                              |
| RECOV.TANK LEVEL  | Water level sensor tripped.                                     | Empty the dirty water tank.                           |
|                   | Level sensor stuck.   | Check the sensor.                                     |
| WATER RESERVE     | Water level sensor tripped.                                     | Fill the solution tank.                               |
|                   | Level sensor stuck.   | Check the sensor.                                     |
| NO WATER          | Water level sensor tripped.                                     | Fill the solution tank.                               |
|                   | Level sensor stuck.   | Check the sensor.                                     |

## DRIVE WHEEL PCB ALARMS

The drive wheel PCB is located inside the steering column. If drive is interrupted, the error code should be identified by means of the status LED. In the absence of malfunctions, the status LED remains permanently alight while the machine is in operation.

☼○○○○○☼○○○○○☼○○○○○☼

example - ALARM A1

☼○☼○○○○○☼○☼○○○○○☼○☼○○○○○☼○☼

example - ALARM A2

☼○☼○☼○☼○☼○☼○☼○☼○☼○☼○☼○☼○☼○☼○☼○○○○○☼

example - ALARM A13

☼○☼○☼○☼○☼○☼○☼○☼○☼○☼○☼○☼○☼○☼○☼○○○○○☼

example - ALARM A14

| ERROR CODE | CAUSE  | SOLUTION        |
|------------|--|-----------------|
| ALARM A1   | Forward Drive switch closed at start-up                    | Contact Service |
| ALARM A2   | Reverse Drive switch closed at start-up                    |                 |
| ALARM A3   | Potentiometer fault  |                 |
| ALARM A4   | Potentiometer not on zero at start-up                      |                 |
| ALARM A5   | Thermal cutout   |                 |
| ALARM A6   | Drive circuit board fault                                  |                 |
| ALARM A7   | Overcurrent (motor fault)                                  |                 |
| ALARM A8   | Fuse or power contacts damaged (drive circuit board fault) |                 |
| ALARM A9   | Undervoltage   |                 |
| ALARM A10  | Overvoltage  |                 |
| ALARM A11  | Overload   |                 |
| ALARM A12  | Disable microswitch active (input fault)                   |                 |
| ALARM A13  | Key shutdown sequence active (input fault)                 |                 |
| ALARM A14  | Internal memory alarm (drive circuit board fault)          |                 |

# USER MENU

To access the user program, turn the ignition key to “1”; after 5 seconds, press the programming button and hold for 10 seconds. The display will show the first parameter. To switch from one parameter to another, use the programming button.

To change the value of the selected parameter, press the “-” or “+” button: “-” to decrease, “+” to increase.

To store the changes and exit, press and hold the programming button until the display shows the battery voltage.

Simply returning the ignition key to “0” will not cancel the changes that have been made; to clear the changes, set the default values shown below and select save.

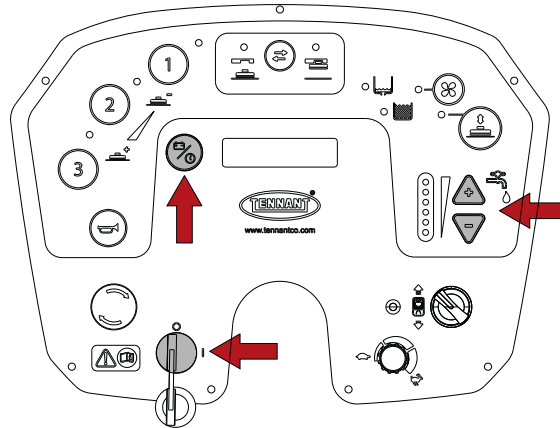

|                       | DEFAULT VALUES                 |                                |
|-----------------------|--------------------------------|--------------------------------|
|                       | Disc Head version              | Roller Head version            |
| Language setting.     | ENGLISH                        | ENGLISH                        |
| Head working pressure | Program 1<br>Pressure 020      | Program 1<br>Pressure 020      |
| Enable brushes        | Program 1<br>Brushes ON        | Program 1<br>Brushes ON        |
| Enable suction unit.  | Program 1<br>Suction ON        | Program 1<br>Suction ON        |
| Water flow rate.      | Program 1<br>Water 2           | Program 1<br>Water 2           |
| Enable Power OFF- ON. | Program 1<br>Auto Power OFF ON | Program 1<br>Auto Power OFF ON |
| Head working pressure | Program 2<br>Pressure 040      | Program 2<br>Pressure 030      |
| Enable brushes        | Program 2<br>Brushes ON        | Program 2<br>Brushes ON        |
| Enable suction unit.  | Program 2<br>Suction ON        | Program 2<br>Suction ON        |
| Water flow rate.      | Program 2<br>Water 3           | Program 2<br>Water 3           |
| Enable Power OFF- ON. | Program 2<br>Auto Power OFF ON | Program 2<br>Auto Power OFF ON |
| Head working pressure | Program 3<br>Pressure 060      | Program 3<br>Pressure 040      |
| Enable brushes        | Program 3<br>Brushes ON        | Program 3<br>Brushes ON        |
| Enable suction unit.  | Program 3<br>Suction ON        | Program 3<br>Suction ON        |
| Water flow rate.      | Program 3<br>Water AUTO        | Program 3<br>Water 3           |
| Enable Power OFF- ON. | Program 3<br>Auto Power OFF ON | Program 3<br>Auto Power OFF ON |
| Chemical flow rate.   | CHEMICAL FLOW 2%               | CHEMICAL FLOW 2%               |

## RECOMMENDED SPARE PARTS

| <b>T981 75cm Cylindrical</b> |                                   |
|------------------------------|-----------------------------------|
| <b>Part Number</b>           | <b>Descriptions</b>               |
| SPPV01286                    | BRUSH, SOFT, PPL, 75CM [STD]      |
| SPPV00457                    | BRUSH, MED, PPL, 75CM             |
| SPPV01364                    | BRUSH, SOFT, MIX 5, 75CM          |
| SPPV01201                    | BRUSH, ABRV, 75CM (TYNEX)         |
| SPPV75790                    | BRUSH, SIDE, PPL, MEDIUM [STD]    |
| SPPV75794                    | BRUSH, SIDE, ABRV                 |
| MPVR06551                    | BLADE, SQGE, FRONT, LINATEX [STD] |
| MPVR06552                    | BLADE, SQGE, REAR, LINATEX [STD]  |
| MPVR02830                    | BLADE, SQGE, FRONT, NAT RUB       |
| MPVR05883                    | BLADE, SQGE, REAR, LATEX          |
| MPVR13250                    | BLADE, SQGE, FRONT, PU            |
| MPVR02832                    | BLADE, SQGE, REAR, PU             |
| PMVR06915                    | SQGE ASY W/ LINATEX BLADES, 75/85 |
| MPVR02846                    | FLAP, SIDE, LEFT                  |
| MPVR02845                    | FLAP, SIDE, RIGHT                 |
| GUVR75740                    | RING                              |
| MPVR04720                    | ROLLER                            |
| MOCC00166                    | MOTOR, BRUSH                      |
| MTCG87404                    | BELT                              |
| CUVR29964                    | BALL BEARING 6000,2RS1 BALL       |
| CUVR00164                    | BEARING 6002RS -SKF               |
| <b>T981 90cm Disk</b>        |                                   |
| <b>Part Number</b>           | <b>Descriptions</b>               |
| SPPV01539                    | BRUSH, PPL, 48CM [STD]            |
| SPPV01540                    | BRUSH, ABRV, 48CM (TYNEX 120)     |
| SPPV01541                    | BRUSH, ABRV, 48CM (TYNEX 240)     |
| SPPV01542                    | BRUSH, ABRV, 48CM (TYNEX 320)     |
| SPPV01543                    | BRUSH, PES, MIX 5, 48CM           |
| SPPV01221                    | PAD HOLDER, 48CM                  |
| 1240392                      | PAD, POLISH, 18.0D, YEL [5PC]     |
| 1243335                      | PAD, SCB, 18.0D, BLU 5PC]         |
| 1243336                      | PAD, BUFF, 18.0D, RED [5PC]       |
| 1243337                      | PAD, POLISH, 18.0D, WHITE [5PC]   |
| 1243660                      | PAD, STRIP, 18.0D BLK [5PC]       |
| 1243724                      | PAD, STRIPPING, 18.0D, BRN [5PC]  |
| MPVR06553                    | BLADE, SQGE, FRONT, LINATEX [STD] |
| MPVR06554                    | BLADE, SQGE, REAR, LINATEX [STD]  |
| MPVR02850                    | BLADE, SQGE, FRONT, NAT RUB       |
| MPVR05884                    | BLADE, SQGE, REAR, LATEX          |
| MPVR13251                    | BLADE, SQGE, FRONT, PU            |
| MPVR51009                    | BLADE, SQGE, REAR, PU             |
| PMVR06916                    | SQGE ASY W/ LINATEX BLADES, 90 cm |
| MPVR51006                    | FLAP, SIDE, LEFT                  |
| MPVR51007                    | FLAP, SIDE, RIGHT                 |
| MPVR51005                    | FLAP, REAR                        |
| MPVR51008                    | FLAP, FRONT                       |
| MOCC00390                    | MOTOR, BRUSH, GEARBOX, RIGHT      |
| MOCC00474                    | MOTOR, BRUSH, GEARBOX, LEFT       |
| RDGR00039                    | GEARBOX, BRUSH MOTOR              |

|                          |  |
|--------------------------|--|
| MEVR05203                | CARBON BRUSHES, BRUSH MOTOR                  |
| 897524                   | BEARING, BALL, 8B 30D 11W                    |
| MLML00240                | SPRING, RETAINER                             |
| <b>T981 Common Parts</b> |  |
| <b>Part Number</b>       | <b>Descriptions</b>                          |
| L-GF06240V               | BATTERY, 6VDC, 240AH, GEL [EXIDE/DELTEC]     |
| L-1070587                | BATTERY, 6VDC, 360AH, WET [TROJAN]           |
| 9001054                  | CHARGER KIT, 36VDC, CI                       |
| 1026325                  | BATTERY CHARGER POWER CORD [DELTA-Q CHARGER] |
| MEVR00985                | VR, BRUSH KIT, MOTOR, TRACTION               |
| MEVR05202                | CARBON BRUSH VACUUM                          |
| FTDP00130                | FILTER                                       |
| GUGO31051                | GASKET LAV                                   |
| KTRI04700                | HOSE, SQUEEGEE                               |
| GUGO00306                | GASKET, CAP, SEAL                            |
| FTAC00038                | FILTER, ASSY, SOLUTION                       |
| FTAC00047                | FILTER, SOLUTION                             |
| 9017783                  | MOTOR, VACUUM, ASSY, 36V                     |
| 9017737                  | SENSOR FLOAT WATER TANK                      |
| TBBP00485                | HOSE ASSY, DRAIN, RECY                       |
| MECB01227                | POTENTIOMETER, TRACTION                      |
| MECB01228                | CONTACT, MICRO, PEDAL                        |
| MEEV00043                | SOLENOID VALVE                               |
| RTRT00518                | WHEEL SWIVEL                                 |
| PMVR01141                | TUBE, AIR OUTLET                             |
| PMVR01139                | HOSE, DRAIN, SOL TANK                        |
| MOCC00394                | ACTUATOR                                     |
| KTRI02060                | ACTUATOR, BRUSH HEAD                         |
| MOCC00380                | MOTOR WHEEL 36V                              |
| RTRT00795                | WHEEL, POLY, D                               |
| PPEL00025                | PUMP EST, 36V                                |
| MECE00526                | BOARD POWER SERVICE                          |
| KTRI06405                | KIT, DISPLAY BOARD ASSY                      |
| KTRI06415                | KIT, BOARD, DISPLAY                          |
| KTRI06416                | KIT, BOARD, LOGIC                            |
| KTRI06417                | KIT, BOARD, INTERFACE                        |
| KTRI05576                | POTENTIOMETER, SPEED 100K                    |
| METT00086                | CONTACTOR, 100A                              |
| RTRT00533                | MOTORWHEEL, RING REPLMT                      |
| CUVR00194                | BEARING, 61926, 2RS                          |
| CUVR00264                | BEARING 32007X                               |
| GUGO00703                | GASKET                                       |
| METT00135                | FUSE 2A                                      |
| METT00132                | FUSE CIRCUIT BREAKER 30A                     |
| METT00136                | FUSE 3A                                      |
| METT00137                | FUSE 4A                                      |
| METT00138                | FUSE 50A                                     |
| MEVR01925                | FUSE 150A                                    |
| 897357                   | BATTERY CABLE                                |
| MECE00927                | CIRCUITBOARD ASSY, TRACTION                  |

**Tennant Company**

10400 Clean Street

Eden Prairie, MN 55344-2650

Phone: (800) 553- 8033

[www.tennantco.com](http://www.tennantco.com)